

**Regular Meeting of the Board of Directors**  
**Lake Don Pedro Community Services District**  
**9751 Merced Falls Road**  
**May 18, 2015, at 1:00 p.m.**

*Mission Statement: The LDPCSD is dedicated to providing potable water that either meets or exceeds all state and federal standards in sufficient quantities to meet the needs of our customers utilizing the most cost effective methods possible while still maintaining a sound financial plan now and for the future.*

**AGENDA**

**1. CALL TO ORDER: Presiding Officer: Establish Quorum, Pledge of Allegiance:**

**2. PUBLIC COMMENT:**

**Any person may address the Board** at this time on any matter within the jurisdiction of the Board that is NOT ON THE AGENDA. A maximum of **three minutes** is allowed each person and a maximum of 20 minutes per topic. Any person wishing to address the Board on an item ON THE AGENDA will be given the opportunity at that time. Speakers are encouraged to consult District Management or Directors prior to agenda preparation regarding any District matters, as no action will be taken on non-agenda issues.

**3. PRESENTATION ONLY:**

- a. Presiding Officer's Report
- b. Interim Manager's Report: Peter J. Kampa
- c. Chief Plant Operator's Report: R. Gilgo
- d. Report: Director Ross ACWA - JPIA Meeting
- e. Report Directors Hankemeier / Day MID Meeting

**4. APPROVAL OF CONSENT AGENDA: The following items may all be approved in one motion or considered separately as determined appropriate by the President**

- a. Read and file the Treasurer's Report
- b. Approval of the Minutes: April 20, 2015 Regular Board Meeting

**5. DISCUSSION AND ACTION ITEMS:**

- a. Report on the Water Supply Emergency Status and progress on emergency water supply projects.
- b. Consideration of the purchase of real property necessary for the emergency water supply project with funds from District reserves.
- c. Consideration of development of a Water Conservation Plan and/or limitations on outside irrigation to two days per week in compliance with the State Water Resources Control Board, Emergency Water Conservation regulations adopted May 5, 2015.
- d. Consideration of amendments to the current water conservation requirements detailed in Resolution 2015-15, to achieve consistency and compliance with the State Water Resources Control Board emergency drought regulations.
- e. Consideration of adoption of an Ordinance restricting the drilling of groundwater wells in the District, due to potential impacts on the emergency groundwater wells.
- f. Discussion regarding the requirements and opportunities related to the use of greywater and rainwater for landscape irrigation.

**6. DIRECTORS COMMENTS:**

Any Director may address the Board on any item of interest that is within the subject matter and jurisdiction of the District. Generally no discussion or comment by other Board members should be expected on non-agenda items, except to properly place the matter on a future agenda for review, discussion or action as appropriate.

**7. CLOSED SESSION:** (California Government Code Section 94956.8)

**Conference with Real Property Negotiator**

The Board will confer with its appointed negotiator, General Manager Peter J. Kampa to discuss price, terms and conditions of a potential real estate transaction related to the Emergency Water Supply Project, property information: Owner – Medina, Location -1620 Zarzamora St., La Grange, CA 95329, Mariposa County Assessor's Parcel No. 020-290-009-0.

**8. ADJOURNMENT**

Meeting agendas and written materials supporting agenda items, if produced, can be received by the public for free in advance of the meeting by any of the following options:

- A paper copy viewed at the District office, 9751 Merced Falls Rd., La Grange, CA 95329 during business hours or mailed pursuant to a written request and payment of associated mailing fees
- An electronic copy received by email. Note - a form requesting email delivery of agendas and/or meeting materials must be completed a minimum of one week in advance of the meeting
- Viewed on the Board page of the District's website
- A limited number of copies of agenda materials will also be available at the meeting

Americans with Disabilities Act Compliance: If you require special assistance to participate in Board Meetings, please contact the LDPCSD Board Secretary at (209) 852-2331. Advance notification will enable the District to make reasonable arrangements to insure accessibility.



# LAKE DON PEDRO

## Community Services District

## General Manager's Report

*May 15, 2015*

### 1 Current Lake McClure water supply outlook

As of May 14, 2015 the water surface elevation of Lake McClure was 624.39 feet above sea level; storage of 114,785 acre feet. The lake elevation continues to increase slowly due to snowmelt runoff and precipitation from the small storms. The reservoir outflow will be reduced through the month of May, pursuant to the Temporary Petition approved on May 11 by the State Water Board. The Petition also allows the District to receive water from Lake McClure even when the reservoir storage volume is less than the minimum pool of 115,000 acre feet, through the end of 2015. In addition, MID is exempt for the State Water Board curtailment order, which would have required that the amount of river inflow into the reservoir be allowed to pass through the dam. The reduction in reservoir outflow will allow the lake water surface elevation to continue to rise slowly through the end of the month, at which time outflow will return to normal limits and we expect the inflow to be low enough that the lake level will begin to drop. Our prediction stands that the lake elevation will drop below our emergency pumps in late October 2015.

### 2 MID meeting of May 11, 2015

On May 11, I met with MID officials regarding a variety of topics, the most important of which is the content of their March 11, 2015 letter to the District. We reviewed the contract amendment from last summer that extends our water supply agreement with MID, under the same terms and conditions through 2016, but had not yet been signed by the District. With the understanding that the contract automatically extends on a year to year basis following its expiration in 2016, I executed the agreement on behalf of the District.

While we were in the meeting, we were notified that the State Water Board had approved MID's request for 1) reduced reservoir outflow in April and May, and 2) the ability to deliver water to the District below the lake's 115,000 acre foot minimum pool. We agreed that the approved petition resolved the concern with District water diversions below Minimum Pool. Also, MID was more than satisfied with our response in repair of the leaking intake pipeline, and planned ongoing rapid response to such problems.

Another concern discussed in our meeting was the reservoir outflow requirements contained in the Federal Energy Regulatory Commission (FERC) Federal Environmental Impact Statement (FEIS) for the relicensing of McClure's hydroelectric facilities. According to MID, as proposed, the new outflow requirements will leave the lake empty in many years, causing the District to have to constantly chase low water levels. MID requests that our District adamantly oppose the outflow requirements, which we will by response letter to FERC.

### **3 Board direction and District projects**

---

We are prepared to launch our contract with the answering service during the week of May 18<sup>th</sup> and the final cost of the service is determined based on actual call volume during the first month. It is expected that the total monthly cost will be less than \$500 per month.

The SCADA system upgrades approved in March 2015 have been completed and the system is now functioning properly with only minor program tweaking necessary to finish the project. This investment saves thousands of dollars annually in operating staff costs, in addition to the tens of thousands of gallons of water saved each year through avoidance of control system miscommunication and tank overflows, etc.

The radio read water meters installed over 4 years ago are now activated, software upgraded, computer and other necessary hardware in place and staff training completed. System testing will be completed the week of May 18 and once the handheld transmitter units are serviced, the system should be live for the June meter reading. Completion of this project will save thousands of dollars in staff cost per month in meter reading time alone, in addition to the capability to quickly find water consumption problems and leaks in the system; which is of critical importance during this drought emergency.

We are nearing closeout on the insurance claim for the office fire that occurred in 2012. There had been a number of financial and accounting issues left incomplete over the past three years which did not allow us to finish the final computer and office technology replacement work, and to close the claim and receive final reimbursement payment. All

renovation work related to the 2012 fire will be completed and final payment received during May 2015. In addition, the repairs had stalled last summer on reconstruction work being completed on damage sustained during the water treatment plant fire, which occurred some time ago. We recently met with the insurance adjuster and immediately restarted the renovations, which should now be completed within the next month.

In March 2015 I was unanimously reappointed to the California Special Districts Association (CSDA) Board of Directors, for a term lasting until 2017. I have also signed up for the CSDA Membership committee, which provides me the direct opportunity to participate in new program development. If there are services not currently available through CSDA that you feel we should provide, please let me know and I will carry them forward.

#### 4 Emergency Water Supply Projects

---

Once again this month, the majority of the management time and effort revolved around emergency water supply planning, project development activities, coordinating and reviewing materials for funding applications. In an attempt to maximize the grant participation in this project construction, we are encountering many delays in project completion. There have been continuous conflicts in both timing and administrative procedure related to the numerous contracts and funding program requirements we must meet. Project scopes of work and associated budgets have been revised dozens of times based on which funding agency is going to fund which wells, and what components of the wells. Some funding programs will only pay for construction, while others will also reimburse us for engineering, planning and other “soft” costs. Some funding agencies will allow the construction of wells to be “exempted” from environmental review under state law, where others require full cultural and biological evaluation under both state and federal environmental review procedures.

#### 5 District Finance

---

The SWRCB, in its emergency drought regulations at Section 10a requires that the District adequately budget for staff and other resources necessary to deal with drought conditions and compliance with the regulations this year and next. In addition, the regulation requires that if we are seeing a budget shortfall due to decreased water sales, that we immediately pursue the steps necessary to raise necessary revenue, in a manner to promote maximum water conservation.

In addition, the state agencies providing us grants and potential loans for emergency groundwater wells, have each stated that we must begin the process of raising water rates immediately due to the lack of cashflow to fund additional debt and needed water system improvements. One agency, as a condition of offering a grant, has required that we begin the rate increase process.

**LAKE DON PEDRO  
COMMUNITY SERVICES DISTRICT**

**Treasurer's Report**

Reporting Period: April 2015

**The district ended the month of April 2015 with the following balances in our accounts:**

\* All bank accounts verified against bank statements

Restricted:	
Investment - LAIF	\$ 162,092
Total Restricted:	<u>\$ 162,092</u>
Unrestricted:	
Checking	\$ 54,727
Money Market - Working Capital	\$ 1,250,910
Petty Cash	<u>\$ 125</u>
Total Unrestricted:	<u>\$ 1,305,762</u>
Total Restricted & Unrestricted:	<u>\$ 1,467,854</u>

**The district ended April 2015 with the following amounts affecting our financial status:**

	Apr-2015	Year to Date
<u>Sales &amp; Business Revenue:</u>	<u>\$ 118,014</u>	<u>\$ 1,225,885</u>
<u>Total Operating Expenses:</u>	<u>\$ (111,292)</u>	<u>\$ (1,087,931)</u>
<u>Non-Operating Income/Expense:</u>	<u>\$ (24,790)</u>	<u>\$ (284,765)</u>
<u>Change in Net Assets (P&amp;L):</u>	<u>\$ (18,068)</u>	<u>\$ (146,811)</u>
<u>Net Cash Flow:</u>	<u>\$ 11,887</u>	<u>\$ (53,281)</u>

Report Submitted by: Peter J. Kampa, District Treasurer

**Accounts Receivable:**

Billing Time Frame	Utility Billing	Availability Billing	A/R Other	Accrued A/R
Current	\$ 21,331	\$ -	\$ -	\$ 95,496
> 30 Days	\$ 6,606	\$ -	\$ 58	\$ -
> 60 Days	\$ 2,759	\$ -	\$ 8	\$ -
> 90 Days	\$ 1,586	\$ -	\$ -	\$ -
> 120 Days	\$ 13,548	\$ 189,870	\$ 17,580	\$ -
Credits	\$ (11,269)			
<b>Total</b>	<b>\$ 34,561</b>	<b>\$ 189,870</b>	<b>\$ 17,646</b>	<b>\$ 95,496</b>
<b>Total Combined</b>	<b>\$ 319,927</b>		<b>\$ 17,646</b>	
 G/L Balance	 \$ 319,927		 \$ 17,646	
 <b>Difference</b>	 <b>\$ 0</b>		 <b>\$ -</b>	

\* Amount of availability payments received: \$164,442

\* Amount of availability payments outstanding: \$25,428

**Accounts Payables:**

Payable Time Frame	A/P Trade	A/P Accruals	A/P Water Accrual
Current	\$ 38,352	\$ -	\$ 5,800
> 30 Days	\$ -	\$ -	\$ 4,579
> 60 Days	\$ -	\$ -	\$ 4,343
> 90 Days	\$ -	\$ -	\$ 6,156
Credits	\$ -	\$ -	\$ -
<b>Total</b>	<b>\$ 38,352</b>	<b>\$ -</b>	<b>\$ 20,878</b>
 G/L Balance	 \$ 38,352	 \$ -	 \$ 20,878
 <b>Difference</b>	 <b>\$0</b>	 <b>\$0</b>	 <b>\$0</b>



**Statement of Revenues and Expenses (P&L)**  
**April 2015 & Year-To-Date Versus 6/30/15 Budget**

		April	2014-2015	YTD vs	2014-2015	Remaining	
	Apr-15	vs Budget %	YTD	Budget %	Budget	Budget	
<b>Revenue</b>							
01-0-3010-301	Meter Reconnection Fee	2,500	10.00%	15,000	60.00%	25,000	10,000
01-0-3010-302	Donated Capital - Meters Curre	-	0.00%	10,000	50.00%	20,000	10,000
01-0-4010-400	Water Sales Residential	17,140	4.45%	255,529	66.37%	385,000	129,471
01-0-4010-402	Water Availability Revenue	15,744	8.29%	158,254	83.33%	189,908	31,654
01-0-4010-403	Water Service Charges	79,136	8.75%	784,102	86.72%	904,186	120,084
01-0-4020-410	Interest Income - LAIF	104	20.78%	395	79.07%	500	105
01-0-4020-413	Int Inc Penalties - Customer	1,321	5.28%	18,725	74.90%	25,000	6,275
01-0-4020-414	Transfer Fee Income	994	11.56%	6,144	71.45%	8,600	2,456
01-0-4020-415	Other Income	(8,682)	-59.88%	(25,006)	-172.46%	14,500	39,506
01-0-4020-416	Meter Set Fee	2,500	62.50%	4,500	112.50%	4,000	(500)
01-0-4020-417	Interest Income Guaranty Fed	31	3.54%	315	36.42%	865	550
01-0-4020-900	Hydrant Service Charge	-	0.00%	-	0.00%	100	100
01-0-4020-901	Hydrant Rental	-	0.00%	40	25.00%	160	120
01-0-4020-902	Hydrant Consumption	-	0.00%	997	302.18%	330	(667)
01-0-4020-999	Avail Fee Income	-	0.00%	1,318	0.00%	-	(1,318)
01-0-4040-100	Lease Fee	2,700	54.00%	18,900	378.00%	5,000	(13,900)
01-0-4050-575	Office Fire Reimbursement	-	0.00%	-	0.00%	18,046	18,046
<b>TOTAL REVENUE</b>		<b>113,487</b>	<b>7.09%</b>	<b>1,249,214</b>	<b>78.02%</b>	<b>1,601,195</b>	<b>351,981</b>
<b>Expenses</b>							
01-1-5010-100	Regular Pay - Plant	11,850	6.96%	126,499	74.29%	170,269	43,771
01-1-5010-101	Overtime Pay	2,195	12.91%	15,086	88.74%	17,000	1,914
01-1-5010-102	Sick Pay	589	9.00%	4,729	72.21%	6,549	1,820
01-1-5010-104	Vacation Pay	1,215	15.95%	4,947	64.97%	7,614	2,667
01-1-5010-105	Holiday Pay	554	5.64%	8,277	84.26%	9,823	1,546
01-1-5010-200	PERS	819	4.79%	8,987	52.58%	17,094	8,107
01-1-5010-201	FICA/Medicare	1,255	7.76%	12,709	78.64%	16,161	3,452
01-1-5010-202	SUI	-	0.00%	1,736	72.33%	2,400	664
01-1-5010-203	Health Insurance	4,443	8.85%	43,324	86.33%	50,182	6,858
01-1-5010-204	Workers Compensation	466	4.23%	2,557	23.24%	11,000	8,443
01-1-5010-206	Dental Insurance	390	9.35%	3,457	82.82%	4,174	717
01-1-5010-207	Vision Care	-	0.00%	-	0.00%	500	500
01-1-5010-546	Travel, Meetings & Mileage	-	0.00%	73	29.38%	250	177
01-1-5020-501	Lease Of Equipment	-	0.00%	369	6.96%	5,300	4,931
01-1-5020-510	Repair & Maintenance - Plant	3,765	22.15%	15,899	93.53%	17,000	1,101
01-1-5020-511	Repair & Maintenance - Vehicle	-	0.00%	10,039	52.83%	19,000	8,961
01-1-5020-512	Repair & Maintenance - Distribution	4,107	15.38%	28,387	106.32%	26,700	(1,687)
01-1-5020-515	R&M Transmission - Intake	-		23,107			
01-1-5020-516	R&M Transmission - Well #1	-		-			
01-1-5020-517	R&M Transmission - Well #2	-		-			
01-1-5020-518	R&M Transmission - 10" Irrigation	-		9,461			
01-1-5020-520	Small Tools & Equipment	-	0.00%	1,471	73.57%	2,000	529
01-1-5020-522	Gas, Oil & Lubricant - Plant	1,552	7.92%	17,029	86.88%	19,600	2,571
01-1-5020-524	Health & Safety	47	0.87%	8,848	163.85%	5,400	(3,448)
01-1-5020-529	Telephone - T & D	386	12.66%	4,329	141.94%	3,050	(1,279)
01-1-5020-535	Water Supply Emergency 2014	21,380		113,830			
01-1-5020-544	Water Testing Fees	540	5.13%	10,085	95.73%	10,535	450
01-1-5020-545	Water System Fees	11,397	94.98%	17,887	149.06%	12,000	(5,887)
01-1-5020-548	Water Testing Materials	-	0.00%	653	12.55%	5,200	4,547
01-1-5021-521	Water Treatment Chemicals	5,796	12.88%	43,019	95.60%	45,000	1,981
01-1-5021-524	P G & E Power - Office	124	4.12%	1,563	52.09%	3,000	1,437
01-1-5021-525	P G & E Power - Intake	4,759	3.97%	97,275	81.06%	120,000	22,725
01-1-5021-526	P G & E Power - Well	660	16.50%	5,187	129.66%	4,000	(1,187)
01-1-5021-527	P G & E Power - Water Treatment	1,373	4.16%	23,281	70.55%	33,000	9,719

		Apr-15	April vs Budget %	2014-2015 YTD	YTD vs Budget %	2014-2015 Budget	Remaining Budget
01-1-5021-528	P G & E Power - Distribution	1,249	4.49%	23,663	85.12%	27,800	4,137
01-1-5021-561	Purchased Water Actual-mid-p	6,129	6.73%	93,638	102.87%	91,030	(2,608)
01-1-5023-533	Outside Services	-	0.00%	2,851	128.44%	2,220	(631)
01-1-5023-535	Fire Protection/Weed Control	-	0.00%	80	13.33%	600	520
01-1-5023-536	Cleaning Services	-	0.00%	-	0.00%	1,000	1,000
01-1-5023-537	Pest Control	32	6.40%	288	57.60%	500	212
01-1-5023-538	Engineering Services	-	0.00%	-	0.00%	7,100	7,100
01-1-5023-539	Employee Education	-	0.00%	180	24.00%	750	570
01-1-5024-540	Memberships	-	0.00%	6,866	528.14%	1,300	(5,566)
01-1-5024-541	Subscriptions	-	0.00%	-	0.00%	200	200
01-1-5024-542	Publications	-	0.00%	322	26.86%	1,200	878
01-1-5024-543	Licenses, Permits & Cert.	-	0.00%	425	18.32%	2,320	1,895
01-1-5032-583	Depreciation Expense	14,097	7.42%	144,144	75.87%	190,000	45,856
01-2-6010-100	Regular Pay - Administration	4,561	5.92%	52,465	68.10%	77,044	24,579
01-2-6010-101	Overtime Pay	284	8.10%	2,906	83.03%	3,500	594
01-2-6010-102	Sick Pay	-	0.00%	-	0.00%	2,160	2,160
01-2-6010-104	Vacation Pay	216	5.00%	1,762	40.78%	4,320	2,558
01-2-6010-105	Holiday Pay	216	7.69%	2,687	95.67%	2,808	122
01-2-6010-200	PERS	435	5.73%	4,956	65.24%	7,597	2,641
01-2-6010-201	FICA/Medicare	409	5.96%	4,814	70.05%	6,872	2,058
01-2-6010-202	SUI	57	4.42%	721	55.50%	1,300	579
01-2-6010-203	Health Insurance	1,520	8.04%	15,474	81.87%	18,900	3,426
01-2-6010-204	Workers Compensation	46	4.85%	253	26.62%	950	697
01-2-6010-206	Dental Insurance	159	9.37%	1,456	85.65%	1,700	244
01-2-6010-207	Vision Care	-	0.00%	-	0.00%	200	200
01-2-6010-546	Travel, Meetings & Mileage	37	0.00%	704	0.00%	200	(504)
01-2-6020-512	Propane	-	0.00%	66	6.60%	1,000	934
01-2-6020-515	Customer Billing Supplies	-	0.00%	458	22.91%	2,000	1,542
01-2-6020-529	Telephone - Admin	449	8.47%	4,340	81.88%	5,300	960
01-2-6020-530	Office Supplies	246	6.15%	1,913	47.82%	4,000	2,087
01-2-6020-531	Postage	449	5.62%	6,649	83.17%	7,995	1,346
01-2-6023-531	Computer IT	2,899	3.62%	17,402	21.75%	80,000	62,598
01-2-6023-532	R & M Equipment	-	0.00%	104	17.29%	600	496
01-2-6023-533	Outside Services	8,690	25.75%	68,842	203.98%	33,750	(35,092)
01-2-6023-535	Office Cleaning Serv	180	12.00%	1,360	90.67%	1,500	140
01-2-6023-536	Legal Services	-	0.00%	21,951	60.97%	36,000	14,049
01-2-6023-537	Audit Services	-	0.00%	7,000	46.67%	15,000	8,000
01-2-6023-538	Engineering Services	-	0.00%	-	0.00%	-	-
01-2-6023-539	Employee Education	-	0.00%	-	0.00%	900	900
01-2-6024-540	Memberships	-	0.00%	2,815	23.46%	12,000	9,185
01-2-6024-541	Subscriptions	-	0.00%	-	0.00%	300	300
01-2-6024-542	Publications	-	0.00%	1,079	31.97%	3,375	2,296
01-2-6024-543	Licenses, Permits & Cert.	-	0.00%	-	0.00%	1,000	1,000
01-2-6024-547	County Fees	-	0.00%	1,926	96.30%	2,000	74
01-3-6025-100	Regular Pay	500	6.33%	8,200	103.80%	7,900	(300)
01-3-6025-201	FICA/Medicare	38	4.17%	627	68.33%	918	291
01-3-6025-202	SUI	-	0.00%	-	0.00%	300	300
01-3-6025-204	Workers Compensation	-	0.00%	-	0.00%	113	113
01-3-6025-546	Travel, Meetings & Mileage	-	0.00%	-	0.00%	400	400
01-3-6025-550	Board Meeting Expense	-	0.00%	-	0.00%	1,300	1,300
01-3-6025-555	Board Election Expenses	-	0.00%	-	0.00%	2,700	2,700
01-9-6030-100	Regular Pay - Non-Departmental	-	0.00%	23,191	27.28%	85,000	61,809
01-9-6030-102	Sick Pay	-	0.00%	-	0.00%	3,269	3,269
01-9-6030-104	Vacation Pay	-	0.00%	4,008	122.61%	3,269	(739)
01-9-6030-105	Holiday Pay	-	0.00%	654	13.33%	4,904	4,250
01-9-6030-106	Other Pay	-	0.00%	1,364	23.92%	5,700	4,336
01-9-6030-200	PERS	-	0.00%	2,388	28.13%	8,487	6,099

		Apr-15	April vs Budget %	2014-2015 YTD	YTD vs Budget %	2014-2015 Budget	Remaining Budget
01-9-6030-201	FICA/Medicare	-	0.00%	2,319	31.43%	7,378	5,059
01-9-6030-202	SUI	-	0.00%		0.00%	1,000	1,000
01-9-6030-203	Health Insurance	-	0.00%	-	0.00%	-	-
01-9-6030-204	Workers Compensation	-	0.00%		0.00%	1,000	1,000
01-9-6030-206	Dental Insurance	-	0.00%		0.00%	-	-
01-9-6030-207	Vision Care	-	0.00%		0.00%	300	300
01-9-6030-546	Travel, Meetings & Mileage	-	0.00%		0.00%	1,500	1,500
01-9-6030-569	Credit Card Service Charges	340	8.51%	3,784	94.59%	4,000	216
01-9-6030-570	Bank Service Charges	-	0.00%	-	0.00%	800	800
01-9-6030-572	Business Insurance Expense	2,488	8.65%	24,883	86.55%	28,750	3,867
01-9-6030-576	Misc Other Expense	64	1.16%	4,261	77.48%	5,500	1,239
01-9-6030-577	Retired Employee Health	1,575	3.91%	30,192	74.92%	40,300	10,108
01-9-6030-580	Retired EE Benefit Expense		0.00%		0.00%	170,000	170,000
01-9-6030-584	SWRCB Well #2	-		2,500			
01-9-6030-585	State Water Board Barge Reimb	-		212			
01-9-6030-586	Dept of Water Resources	-		79,810			
01-9-6030-587	State Revolving Fund						
01-9-6031-580	Interest Long Term Debt	4,260	7.94%	44,263	82.54%	53,624	9,361
01-9-6031-581	Other Interest Charges		0.00%		0.00%	100	100
01-9-6032-583	Depreciation Expense	267	4.46%	2,710	45.17%	6,000	3,290
<b>TOTAL EXPENSES</b>		<b>131,555</b>	<b>7.52%</b>	<b>1,396,024</b>	<b>79.84%</b>	<b>1,748,604</b>	<b>352,580</b>
<b>Total Revenue</b>		<b>113,487</b>	<b>7.09%</b>	<b>1,249,214</b>	<b>78.02%</b>	<b>1,601,195</b>	<b>351,981</b>
<b>Total Expense</b>		<b>131,555</b>	<b>7.52%</b>	<b>1,396,024</b>	<b>79.84%</b>	<b>1,748,604</b>	<b>352,580</b>
<b>Net Income / (Loss)</b>		<b>(18,068)</b>	<b>12.26%</b>	<b>(146,811)</b>	<b>99.59%</b>	<b>(147,409)</b>	<b>(598)</b>

\* Total income and expenses are different from the Statement of Revenue & Expenses due to how the finance and non-operating income are combined. Net income is identical.

LDPDSD CASH AVAILABILITY AND BANK RECONCILIATION as of month ending 4/30/2015

(exclude petty cash @\$125)

	3/31/2015	Checking	MM	Invest/LAIF	Petty Cash	Total
Begin Balance (Last Pd. Ending)	47,102	1,246,752	161,988	125	1,455,967	
AP - Checks Issued (list attached)	(117,609)				(117,609)	
Payroll - Checks & Direct Deposits	(16,117)				(16,117)	
Payroll Wires - Taxes & Benefits	(9,649)				(9,649)	
Cash receipts		151,000	155,322		155,322	
Transfer in/-out			(151,000)			
Bank charges	serv chg		(547)		(547)	
	nsf					
	ach cr		352		352	
	ach dr					
Interest Income			31	104	135	
Misc (deposit-withdrawal)						
Voided Checks from Current Month						
Accrue bank deposit adjustment						
<b>Ending Balance</b>	<b>54,727</b>	<b>1,250,910</b>	<b>162,092</b>	<b>125</b>	<b>1,467,854</b>	
Reconcile: cash in transit						
outstanding checks	27,401	(18,970)			8,431	
misc: ach credit /debit						
misc: corrections to come						
<b>Bank Balance (verified against bank statements)</b>	<b>82,128</b>	<b>1,231,940</b>	<b>162,092</b>	<b>125</b>	<b>1,476,285</b>	
Restricted:			162,092		162,092	
Unrestricted:				125	1,305,762	
Resolution: Emergency	54,727	1,250,910				
Project replacement						

		<u>Amount</u>
<b>ACWA/JPIA</b>		
<b>000165 ACWA/JPIA</b>		
Ck. 21561	04/14/15	
Inv. 0345142		
<u>Line Item Date</u>	<u>Line Item Description</u>	
04/02/15	Connie	(499.15)
04/02/15	Connie	(499.15)
04/02/15	Margaret	484.74
04/02/15	Janet	484.74
04/02/15	Kyle	746.42
04/02/15	Joseph	746.42
04/02/15	Cody	746.42
04/02/15	Connie	801.96
04/02/15	Daniel	801.96
04/02/15	Syndie	1,519.78
04/02/15	Randy	2,203.90
Inv. 0345142 Total		7,538.04
Ck. 21561 Total		7,538.04
<b>000165</b>	<b>ACWA/JPIA</b>	<b>7,538.04</b>
<b>ACWA/JPIA</b>		<b>7,538.04</b>
<b>AQUA LAB</b>		
<b>000012 AQUA LAB</b>		
Ck. 21549	04/06/15	
Inv. 13808		
<u>Line Item Date</u>	<u>Line Item Description</u>	
03/01/15	AquaLab water testing	860.00
Inv. 13808 Total		860.00
Ck. 21549 Total		860.00
<b>000012</b>	<b>AQUA LAB</b>	<b>860.00</b>
<b>AQUA LAB</b>		<b>860.00</b>
<b>AQUA SIERRA CONTROLS, INC</b>		
<b>000196 AQUA SIERRA CONTROLS, INC</b>		
Ck. 21579	04/28/15	
Inv. 26141		
<u>Line Item Date</u>	<u>Line Item Description</u>	
04/16/15	Aqua Sierra network based RTU	4,278.94
Inv. 26141 Total		4,278.94
Ck. 21579 Total		4,278.94
<b>000196</b>	<b>AQUA SIERRA CONTROLS, INC</b>	<b>4,278.94</b>
<b>AQUA SIERRA CONTROLS, INC</b>		<b>4,278.94</b>
<b>AT&amp;T</b>		
<b>000136 AT&amp;T</b>		
Ck. 21573	04/28/15	
Inv. 209852-23314566		
<u>Line Item Date</u>	<u>Line Item Description</u>	
04/11/15	AT&T telephone	183.31
04/11/15	AT&T telephone	448.80

	<u>Amount</u>
Inv. 209852-23314566 Total	632.11
Ck. 21573 Total	632.11
<b>000136 AT&amp;T</b>	<b>632.11</b>
<b>AT&amp;T</b>	<b>632.11</b>
<b>BINKLEY ASSOCIATES, INC</b>	
<b>000106 BINKLEY ASSOCIATES, INC</b>	
Ck. 21570 04/28/15	
Inv. 04-15-02	
<u>Line Item Date</u> <u>Line Item Description</u>	
04/20/15              Binkley professional services	1,540.00
Inv. 04-15-02 Total	1,540.00
Ck. 21570 Total	1,540.00
<b>000106 BINKLEY ASSOCIATES, INC</b>	<b>1,540.00</b>
<b>BINKLEY ASSOCIATES, INC</b>	<b>1,540.00</b>
<b>BUSINESS CARD</b>	
<b>000383 BUSINESS CARD</b>	
Ck. 21580 04/28/15	
Inv. 4723	
<u>Line Item Date</u> <u>Line Item Description</u>	
04/15/15              Jose BofA credit card	1.93
04/15/15              Jose BofA credit card	7.71
04/15/15              Jose BofA credit card	398.81
Inv. 4723 Total	408.45
Ck. 21580 Total	408.45
Ck. 21581 04/28/15	
Inv. 9921	
<u>Line Item Date</u> <u>Line Item Description</u>	
04/15/15              Randy BofA card	19.27
04/15/15              Randy BofA card	39.98
04/15/15              Randy BofA card	40.33
04/15/15              Randy BofA card	348.36
Inv. 9921 Total	447.94
Ck. 21581 Total	447.94
Ck. 21582 04/28/15	
Inv. 6075	
<u>Line Item Date</u> <u>Line Item Description</u>	
04/15/15              Syndie BofA card	37.08
Inv. 6075 Total	37.08
Ck. 21582 Total	37.08
Ck. 21583 04/28/15	
Inv. 2333	
<u>Line Item Date</u> <u>Line Item Description</u>	
04/15/15              Ann BofA card	7.95
Inv. 2333 Total	7.95

		<u>Amount</u>
Ck. 21583 Total		7.95
<b>000383</b>	<b>BUSINESS CARD</b>	<b>901.42</b>
<b>BUSINESS CARD</b>		<b>901.42</b>
<b>CHEMCO PRODUCTS COMPANY</b>		
<b>000025</b>	<b>CHEMCO PRODUCTS COMPANY</b>	
Ck. 21547	04/06/15	
Inv. 81548		
<u>Line Item Date</u>	<u>Line Item Description</u>	
03/24/15	Chemco water treatment	6,417.76
Inv. 81548 Total		6,417.76
Ck. 21547 Total		6,417.76
<b>000025</b>	<b>CHEMCO PRODUCTS COMPANY</b>	<b>6,417.76</b>
<b>CHEMCO PRODUCTS COMPANY</b>		<b>6,417.76</b>
<b>COPY KING</b>		
<b>000583</b>	<b>COPY KING</b>	
Ck. 21565	04/20/15	
Inv. 2393		
<u>Line Item Date</u>	<u>Line Item Description</u>	
04/06/15	Copy King supplies	246.02
Inv. 2393 Total		246.02
Ck. 21565 Total		246.02
<b>000583</b>	<b>COPY KING</b>	<b>246.02</b>
<b>COPY KING</b>		<b>246.02</b>
<b>D &amp; D PEST CONTROL *</b>		
<b>000118</b>	<b>D &amp; D PEST CONTROL *</b>	
Ck. 21566	04/20/15	
Inv. 0343457		
<u>Line Item Date</u>	<u>Line Item Description</u>	
04/16/15	D&D Pest Control	32.00
Inv. 0343457 Total		32.00
Ck. 21566 Total		32.00
<b>000118</b>	<b>D &amp; D PEST CONTROL *</b>	<b>32.00</b>
<b>D &amp; D PEST CONTROL *</b>		<b>32.00</b>
<b>GRISWOLD, LaSALLE, COBB, DOWD</b>		
<b>000203</b>	<b>GRISWOLD, LaSALLE, COBB, DOWD</b>	
Ck. 21555	04/14/15	
Inv. 17983		
<u>Line Item Date</u>	<u>Line Item Description</u>	
03/25/15	Griswold legal services	30.00
03/25/15	Griswold legal services	1,287.00
Inv. 17983 Total		1,317.00

		<u>Amount</u>
Ck. 21555 Total		1,317.00
<b>000203</b>	<b>GRISWOLD, LaSALLE, COBB, DOWD</b>	<b>1,317.00</b>
<b>GRISWOLD, LaSALLE, COBB, DOWD</b>		<b>1,317.00</b>
<b>HD Supply Water Works, LTD</b>		
<b>10107 HD Supply Water Works, LTD</b>		
Ck. 21546	04/06/15	
Inv. D700220		
<u>Line Item Date</u>	<u>Line Item Description</u>	
03/31/15	HD Supply rapairs	738.09
Inv. D700220 Total		738.09
Ck. 21546 Total		738.09
<b>10107</b>	<b>HD Supply Water Works, LTD</b>	<b>738.09</b>
<b>HD Supply Water Works, LTD</b>		<b>738.09</b>
<b>KAMPA COMMUNITY SOLUTIONS LLC</b>		
<b>0003221 KAMPA COMMUNITY SOLUTIONS LLC</b>		
Ck. 21567	04/20/15	
Inv. 2015 LDPCSD 4		
<u>Line Item Date</u>	<u>Line Item Description</u>	
04/06/15	Kampa general management services	6,250.00
Inv. 2015 LDPCSD 4 Total		6,250.00
Inv. Emergency 3		
<u>Line Item Date</u>	<u>Line Item Description</u>	
04/10/15	Kampa emergency drought services	6,400.00
Inv. Emergency 3 Total		6,400.00
Ck. 21567 Total		12,650.00
<b>0003221</b>	<b>KAMPA COMMUNITY SOLUTIONS LLC</b>	<b>12,650.00</b>
<b>KAMPA COMMUNITY SOLUTIONS LLC</b>		<b>12,650.00</b>
<b>Kennedy/Jenks Consultants</b>		
<b>0000303 Kennedy/Jenks Consultants</b>		
Ck. 21548	04/06/15	
Inv. 90936		
<u>Line Item Date</u>	<u>Line Item Description</u>	
03/25/15	Kennedy Jenks professional services	37,720.80
Inv. 90936 Total		37,720.80
Ck. 21548 Total		37,720.80
<b>0000303</b>	<b>Kennedy/Jenks Consultants</b>	<b>37,720.80</b>
<b>Kennedy/Jenks Consultants</b>		<b>37,720.80</b>



		<u>Amount</u>
<b>KKI CORPORATION</b>		
<b>000065 KKI CORPORATION</b>		
Ck. 21557	04/14/15	
Inv. 950316		
<u>Line Item Date</u>	<u>Line Item Description</u>	
03/31/15	KKI support	324.00
Inv. 950316 Total		324.00
Ck. 21557 Total		324.00
Ck. 21564	04/20/15	
Inv. 950119		
<u>Line Item Date</u>	<u>Line Item Description</u>	
04/01/15	KKI general support	1,215.00
Inv. 950119 Total		1,215.00
Ck. 21564 Total		1,215.00
Ck. 21568	04/28/15	
Inv. 00505114		
<u>Line Item Date</u>	<u>Line Item Description</u>	
04/20/15	KKI computer services	737.80
Inv. 00505114 Total		737.80
Ck. 21568 Total		737.80
<b>000065</b>	<b>KKI CORPORATION</b>	<b>2,276.80</b>
<b>KKI CORPORATION</b>		<b>2,276.80</b>
<b>LAWSON &amp; SON BACKHOE &amp; GRADIN</b>		
<b>000047 LAWSON &amp; SON BACKHOE &amp; GRADIN</b>		
Ck. 21577	04/28/15	
Inv. 7376		
<u>Line Item Date</u>	<u>Line Item Description</u>	
04/21/15	Lawson & son repairs	3,555.00
Inv. 7376 Total		3,555.00
Ck. 21577 Total		3,555.00
<b>000047</b>	<b>LAWSON &amp; SON BACKHOE &amp; GRADIN</b>	<b>3,555.00</b>
<b>LAWSON &amp; SON BACKHOE &amp; GRADIN</b>		<b>3,555.00</b>
<b>LUIS'S HOUSEKEEPING / YARDS</b>		
<b>000550 LUIS'S HOUSEKEEPING / YARDS</b>		
Ck. 21563	04/20/15	
Inv. 158208		
<u>Line Item Date</u>	<u>Line Item Description</u>	
04/01/15	March office cleaning	80.00
Inv. 158208 Total		80.00
Ck. 21563 Total		80.00
Ck. 21571	04/28/15	
Inv. 158216		
<u>Line Item Date</u>	<u>Line Item Description</u>	
04/24/15	April office cleaning	100.00

		<u>Amount</u>
Inv. 158216	Total	100.00
Ck. 21571	Total	100.00
<b>000550</b>	<b>LUIS'S HOUSEKEEPING / YARDS</b>	<b>180.00</b>
<b>LUIS'S HOUSEKEEPING / YARDS</b>		<b>180.00</b>
<b>MO CAL OFFICE SOLUTIONS</b>		
<b>000585</b>	<b>MO CAL OFFICE SOLUTIONS</b>	
Ck. 21572	04/28/15	
Inv. AR214835		
<u>Line Item Date</u>	<u>Line Item Description</u>	
04/22/15	Mo-Cal equipment rental	112.80
Inv. AR214835	Total	112.80
Ck. 21572	Total	112.80
<b>000585</b>	<b>MO CAL OFFICE SOLUTIONS</b>	<b>112.80</b>
<b>MO CAL OFFICE SOLUTIONS</b>		<b>112.80</b>
<b>NATIONAL LOAN INVESTORS, LP</b>		
<b>UB*10385</b>	<b>NATIONAL LOAN INVESTORS, LP</b>	
Ck. 21553	04/06/15	
Inv.		
<u>Line Item Date</u>	<u>Line Item Description</u>	
03/30/15	Refund check	55.00
03/30/15	Refund check	98.00
Inv. Total		153.00
Ck. 21553	Total	153.00
<b>UB*10385</b>	<b>NATIONAL LOAN INVESTORS, LP</b>	<b>153.00</b>
<b>NATIONAL LOAN INVESTORS, LP</b>		<b>153.00</b>
<b>ODESHO, BITRIS</b>		
<b>UB*10386</b>	<b>ODESHO, BITRIS</b>	
Ck. 21554	04/06/15	
Inv.		
<u>Line Item Date</u>	<u>Line Item Description</u>	
03/30/15	Refund check	57.60
Inv. Total		57.60
Ck. 21554	Total	57.60
<b>UB*10386</b>	<b>ODESHO, BITRIS</b>	<b>57.60</b>
<b>ODESHO, BITRIS</b>		<b>57.60</b>
<b>OLIN CORPORATION</b>		
<b>000237</b>	<b>OLIN CORPORATION</b>	
Ck. 21575	04/28/15	
Inv. 1985945		
<u>Line Item Date</u>	<u>Line Item Description</u>	
04/16/15	Olin treatment chemicals	601.91

		<u>Amount</u>
Inv. 1985945	Total	601.91
Ck. 21575	Total	601.91
<b>000237</b>	<b>OLIN CORPORATION</b>	<b>601.91</b>
<b>OLIN CORPORATION</b>		<b>601.91</b>
<b>PACIFIC GAS &amp; ELECTRIC</b>		
<b>000105</b>	<b>PACIFIC GAS &amp; ELECTRIC</b>	
Ck. 21544	04/06/15	
Inv. 0007429963-7		
<u>Line Item Date</u>	<u>Line Item Description</u>	
03/26/15	EP Ranchito Dr La Grange	1,000.00
Inv. 0007429963-7	Total	1,000.00
Ck. 21544	Total	1,000.00
Ck. 21556	04/14/15	
Inv. 7043447813-0		
<u>Line Item Date</u>	<u>Line Item Description</u>	
03/30/15	Stertivant Water Tank	13.75
03/30/15	Water Tank Press	22.97
03/30/15	Arbolada Boost	30.40
03/30/15	Alamo booster	40.27
03/30/15	Tulipan Way	78.35
03/30/15	Office	82.32
03/30/15	Coronado Booster	401.46
03/30/15	Central Station	446.26
03/30/15	Enebro Boos	468.24
03/30/15	Well	683.18
03/30/15	WTR Treatment Plant	1,307.35
03/30/15	SE NW 26 3 15	4,485.52
Inv. 7043447813-0	Total	8,060.07
Ck. 21556	Total	8,060.07
<b>000105</b>	<b>PACIFIC GAS &amp; ELECTRIC</b>	<b>9,060.07</b>
<b>PACIFIC GAS &amp; ELECTRIC</b>		<b>9,060.07</b>
<b>PAINTER, TRUSTEE, HOWARD</b>		
<b>UB*10383</b>	<b>PAINTER, TRUSTEE, HOWARD</b>	
Ck. 21551	04/06/15	
Inv.		
<u>Line Item Date</u>	<u>Line Item Description</u>	
03/30/15	Refund check	5.50
03/30/15	Refund check	75.06
Inv. Total		80.56
Ck. 21551	Total	80.56
<b>UB*10383</b>	<b>PAINTER, TRUSTEE, HOWARD</b>	<b>80.56</b>
<b>PAINTER, TRUSTEE, HOWARD</b>		<b>80.56</b>

			<u>Amount</u>
<b>Robin Impastato</b>			
<b>0001754 Robin Impastato</b>			
Ck. 21560	04/14/15		
Inv.			
<u>Line Item Date</u>	<u>Line Item Description</u>		
03/31/15	to replace ck #21504		135.34
Inv. Total			135.34
Ck. 21560 Total			135.34
<b>0001754</b>	<b>Robin Impastato</b>		<b>135.34</b>
<b>Robin Impastato</b>			<b>135.34</b>
<b>ROSEMIRE, RICHARD / MARIE</b>			
<b>UB*10382 ROSEMIRE, RICHARD / MARIE</b>			
Ck. 21550	04/06/15		
Inv.			
<u>Line Item Date</u>	<u>Line Item Description</u>		
03/30/15	Refund check		2.00
03/30/15	Refund check		115.96
Inv. Total			117.96
Ck. 21550 Total			117.96
<b>UB*10382</b>	<b>ROSEMIRE, RICHARD / MARIE</b>		<b>117.96</b>
<b>ROSEMIRE, RICHARD / MARIE</b>			<b>117.96</b>
<b>SDRMA Wrk Comp/QTR</b>			
<b>000110 SDRMA Wrk Comp/QTR</b>			
Ck. 21559	04/14/15		
Inv. 50259			
<u>Line Item Date</u>	<u>Line Item Description</u>		
03/02/15	SDRMA worker's comp April - June		1,535.00
Inv. 50259 Total			1,535.00
Ck. 21559 Total			1,535.00
<b>000110</b>	<b>SDRMA Wrk Comp/QTR</b>		<b>1,535.00</b>
<b>SDRMA Wrk Comp/QTR</b>			<b>1,535.00</b>
<b>SIERRA MARIPOSA PROPERTIES, LL</b>			
<b>UB*10384 SIERRA MARIPOSA PROPERTIES, LL</b>			
Ck. 21552	04/06/15		
Inv.			
<u>Line Item Date</u>	<u>Line Item Description</u>		
03/30/15	Refund check		89.16
Inv. Total			89.16
Ck. 21552 Total			89.16
<b>UB*10384</b>	<b>SIERRA MARIPOSA PROPERTIES, LL</b>		<b>89.16</b>
<b>SIERRA MARIPOSA PROPERTIES, LL</b>			<b>89.16</b>

			<u>Amount</u>
<b>Sierra Telephone</b>			
<b>101000 Sierra Telephone</b>			
Ck. 21576	04/28/15		
Inv. 1900012840			
<u>Line Item Date</u>	<u>Line Item Description</u>		
04/15/15	Sierra Telephone charges		50.50
Inv. 1900012840	Total		50.50
Ck. 21576	Total		50.50
<b>101000</b>	<b>Sierra Telephone</b>		<b>50.50</b>
<b>Sierra Telephone</b>			<b>50.50</b>
<b>SWRCB Accounting Office</b>			
<b>001888 SWRCB Accounting Office</b>			
Ck. 21574	04/28/15		
Inv. LW-1000694			
<u>Line Item Date</u>	<u>Line Item Description</u>		
04/14/15	CA Water Board fees		11,397.12
Inv. LW-1000694	Total		11,397.12
Ck. 21574	Total		11,397.12
<b>001888</b>	<b>SWRCB Accounting Office</b>		<b>11,397.12</b>
<b>SWRCB Accounting Office</b>			<b>11,397.12</b>
<b>The Source Group Inc</b>			
<b>0003478 The Source Group Inc</b>			
Ck. 21545	04/06/15		
Inv. 501645			
<u>Line Item Date</u>	<u>Line Item Description</u>		
03/01/14	Emergency well siting evaluation		8,123.63
Inv. 501645	Total		8,123.63
Ck. 21545	Total		8,123.63
Ck. 21569	04/28/15		
Inv. 501691			
<u>Line Item Date</u>	<u>Line Item Description</u>		
04/01/15	Source Group well evaluations		1,330.00
Inv. 501691	Total		1,330.00
Ck. 21569	Total		1,330.00
<b>0003478</b>	<b>The Source Group Inc</b>		<b>9,453.63</b>
<b>The Source Group Inc</b>			<b>9,453.63</b>
<b>USPS</b>			
<b>000076 USPS</b>			
Ck. 23214	04/01/15		
Inv. 04012015			
<u>Line Item Date</u>	<u>Line Item Description</u>		
04/01/15	Postage for UB April Billing		441.26
Inv. 04012015	Total		441.26

		<u>Amount</u>
Ck. 23214	Total	441.26
<b>000076</b>	<b>USPS</b>	<b>441.26</b>
<b>USPS</b>		<b>441.26</b>
<b>VALERO MARKETING &amp; SUPPLY</b>		
<b>000091 VALERO MARKETING &amp; SUPPLY</b>		
Ck. 21562	04/20/15	
Inv. 7148 6948		
<u>Line Item Date</u>	<u>Line Item Description</u>	
04/08/15	Joseph valero charges	272.30
04/08/15	Randy valero charges	532.55
Inv. 7148 6948	Total	804.85
Ck. 21562	Total	804.85
<b>000091</b>	<b>VALERO MARKETING &amp; SUPPLY</b>	<b>804.85</b>
<b>VALERO MARKETING &amp; SUPPLY</b>		<b>804.85</b>
<b>VERIZON WIRELESS</b>		
<b>660108 VERIZON WIRELESS</b>		
Ck. 21578	04/28/15	
Inv. 9743949462		
<u>Line Item Date</u>	<u>Line Item Description</u>	
04/13/15	Verizon telephone charges	152.26
Inv. 9743949462	Total	152.26
Ck. 21578	Total	152.26
<b>660108</b>	<b>VERIZON WIRELESS</b>	<b>152.26</b>
<b>VERIZON WIRELESS</b>		<b>152.26</b>
<b>Warmerdam CPA Group</b>		
<b>702 Warmerdam CPA Group</b>		
Ck. 21558	04/14/15	
Inv. 12926		
<u>Line Item Date</u>	<u>Line Item Description</u>	
03/31/15	Warmerdam CPA fees	2,482.00
Inv. 12926	Total	2,482.00
Ck. 21558	Total	2,482.00
<b>702</b>	<b>Warmerdam CPA Group</b>	<b>2,482.00</b>
<b>Warmerdam CPA Group</b>		<b>2,482.00</b>
<b>Total</b>		<b>117,609.00</b>

**LDPCSD Financials****Statement of Net Assets (Balance Sheet)  
for the month ending April 30, 2015****Asset :**

Cash and investments	\$	1,467,854
Restricted cash	\$	-
Accts Receivable net of res	\$	141,486
Inventory	\$	69,646
Prpd expense & deposits	\$	7,666
Other assets		
Total current assets	\$	1,686,652

Property, plant & equipment	\$	9,081,656
less depreciation	\$	(6,470,487)
C I P	\$	613,089
Net P P & E	\$	3,224,258

**Other L T Assets**

Total Assets \$ 4,910,910

**Liabilites:**

Accounts payable	\$	38,352
Interest payable	\$	6,390
Water Accrual	\$	20,877
L T debt, current	\$	68,659
Total current liab	\$	134,278

**L T debt**

Post Retirement Benefit	\$	749,138
Muni Loan	\$	1,034,065
less current above	\$	(68,659)

Total Liabilites \$ 1,848,822

Net assets \$ 3,062,088

Total liab & net ass't \$ 4,910,910

**LDPCSD****Statement of Revenue & Expenses (P&L)  
for the month ending April 30, 2015**

	Plan
(- unfavorable except inc)	
Sales & Business revenue	\$ 118,014
Water, mat'ls, elect & testing	\$ 31,903
Value-add cont'n (output)	\$ 86,111
Value-add ratio	0.80
Compensation expense	\$ 33,291
Other direct prod'n exp	\$ 9,889
Other direct office exp	\$ 13,036
Professional support	\$ -
Water Drought exp	\$ 21,380
Rent, Ins, Tech/legal req'd	\$ 2,488
Other operating expense	\$ 9,013
Dep'n/Amort'n expense	\$ 14,364
Finance & related (inc - )	\$ 3,145
Board of Directors' expense	\$ 538
Transfer out	\$ -
Total Prod'n Exp (input)	\$ 107,144
Net Contribution from prod'n	\$ (21,033)
Non-oper income (-)/exp	\$ (2,965)
Change in net assets (P&L[-])	\$ (18,068)

## Statistics:

Acre feet (pumped)- lake

Acre feet (pumped)- well

Acre feet - sold



**LDPCSD****Statements of Cash Flows****(indirect method) for the Month ending April 30, 2015****(- unfavorable) Plan**

Chng in net assets (P&L)	\$	(18,068)
Non-cash items in Chng (P&L):		
Dep'n/Amort'n expense	\$	14,364
Other non-cash items		
net cash flow	\$	(3,704)
Working Capital changes:		
Accts Rec	\$	41,505
Inventories	\$	-
Prpd & deposits	\$	3,833
Accts pay & Acc'd Payroll	\$	(30,860)
Water Accrual and Interest Accrual	\$	10,388
net cash flow	\$	21,162
P P & E purchased	\$	-
C I P purchases	\$	(9,275)
less new loans acquired		
net cash flow	\$	11,887
Finance & other activities:		
L T loan payments	\$	-
Other	\$	-
Cash flow	\$	11,887
Beginning cash balance	\$	1,455,967
Ending cash balance	\$	1,467,854

# Lake Don Pedro Community Services District

## Regular Meeting of May 18, 2015

### AGENDA SUPPORTING DATA

#### 5. DISCUSSION AND ACTION ITEMS:

- a. Report on the Water Supply Emergency Status and progress on emergency water supply projects.

#### **Background**

Included with this agenda item are numerous documents that will be discussed in detail at the meeting. The General Manager's report covers the water supply available in Lake McClure and predictions that the water remaining in the lake will last until late October 2015. The projects will be discussed in detail during the meeting.

An emergency groundwater well project budget is included for discussion, and contains the total project cost of \$2 million, and a listing of the various funding agencies and their contributions to the various components of the project. Please note that this budget will be amended to reflect decisions made in this meeting and new funding sources offered on May 15, 2015.

#### **Recommended Motion**

Information only

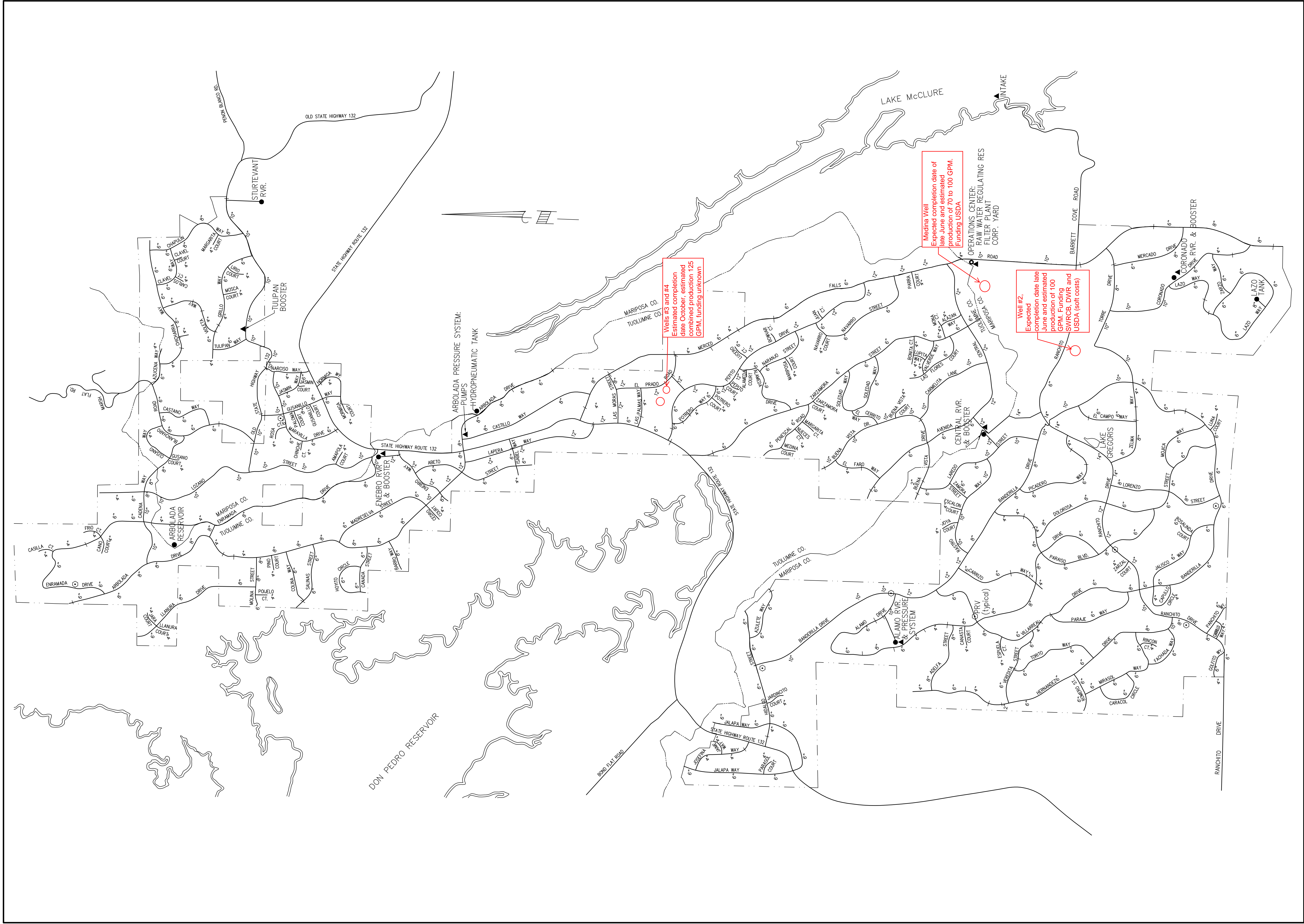

REVISIONS	BY

**Binkley Associates**  
CONSULTING ENGINEERS  
7246 SHARON DRIVE • SAN JOSE • CALIFORNIA 95129 • (408) 257-9252

**SYSTEM MAP**

LAKE DON PEDRO  
COMMUNITY SERVICES DISTRICT  
TUOLUMNE AND MARIPOSA COUNTIES

DATE:	1/11/05
SCALE:	1" = 1320'
DRAWN:	TN
DWG.#	OSYSMAP
SHEET	1
OF	1 SHEETS

Lake Don Pedro CSD  
 Emergency Groundwater Well Project  
 Groundwater Supply VS Demand Calculations

GPM Well Production	GPD Well Production	AF/D Well Production	Peak Demand, AF/day	Shortage	Peak Demand AF/day (30% conservation)	Shortage (with conservation)
200	288000	0.88	2.13	-1.25	1.491	-0.61
250	360000	1.10	2.13	-1.03	1.491	-0.39
300	432000	1.33	2.13	-0.80	1.491	-0.17
350	504000	1.55	2.13	-0.58	1.491	0.06
400	576000	1.77	2.13	-0.36	1.491	0.28
450	648000	1.99	2.13	-0.14	1.491	0.50
500	720000	2.21	2.13	0.08	1.491	0.72

4 Year Average Demand	
	AF/day
January	0.67
February	0.61
March	0.75
April	0.85
May	1.28
June	1.54
July	1.90
August	1.79
September	1.63
October	1.31
November	0.90
December	0.72

Lake Don Pedro Community Services District  
 Emergency Groundwater Well Project: Work Scope, Budget, Funding Source, and Schedule  
 April 29, 2015

Well 2: Phase 1 - Planning/Engineering/Environmental

Task No.:	Task Description:	Cost:	DWR:	SWRCB:	USDA:	HMGP:	SRF:	District:	Completion Date:
1	Project Evaluations and Pre-Design Engineering	\$ 30,000.00			\$ 30,000.00				4/15/2015
2	Plans, Specifications, and Estimates (PS&E)	\$ 30,000.00			\$ 30,000.00				5/15/2015
3	Environmental Documents	\$ 3,500.00			\$ 3,500.00				5/15/2015
4	Right-of-Way (ROW) Acquisition	\$ 15,000.00			\$ 15,000.00				5/15/2015
5	Permitting	\$ 1,500.00			\$ 1,500.00				7/15/2015
6	Project Management	\$ 10,000.00			\$ 10,000.00				7/31/2015
Total:		\$ 90,000.00	\$ -	\$ -	\$ 90,000.00	\$ -	\$ -	\$ -	

Well 2: Phase 2 - Construction

Task No.:	Task Description:	Cost:	DWR:	SWRCB:	USDA:	HMGP:	SRF:	District:	Completion Date:
1	Test Hole Drilling, Sampling, Logging, Testing (Assume 8 Test Holes)	\$ 88,000.00	\$ 83,000.00					\$ 5,000.00	3/31/2015
2	Well Drilling, Install Casing and Screening, Development, and Testing	\$ 50,000.00	\$ 45,000.00					\$ 5,000.00	5/31/2015
3	Well Equipping, Mechanical, Electrical, and Controls	\$ 60,000.00	\$ 60,000.00						6/30/2015
4	Site Improvements and Fencing	\$ 10,000.00	\$ 10,000.00						6/30/2015
5	Power Source Improvements	\$ 25,000.00	\$ 2,000.00	\$ 23,000.00					6/30/2015
6	Connection to Raw Water System, Pipe, Valving, Surface Restoration	\$ 15,000.00		\$ 15,000.00					6/30/2015
	Contingency (12%)	\$ 29,760.00		\$ 29,760.00					6/30/2015
Total:		\$ 277,760.00	\$ 200,000.00	\$ 67,760.00	\$ -	\$ -	\$ -	\$ 10,000.00	

Well 2: Phase 3 - Construction Management/Inspection/Project Closeout

Task No.:	Task Description:	Cost:	DWR:	SWRCB:	USDA:	HMGP:	SRF:	District:	Completion Date:
1	Resident Engineering	\$ 10,000.00			\$ 10,000.00				6/30/2015
2	Construction Surveying	\$ 2,500.00			\$ 2,500.00				6/30/2015
3	Inspection	\$ 10,000.00			\$ 10,000.00				6/30/2015
4	Project Closeout	\$ 2,500.00			\$ 2,500.00				7/31/2015
Total:		\$ 25,000.00	\$ -	\$ -	\$ 25,000.00	\$ -	\$ -	\$ -	

Well 2 Total: \$ 392,760.00 \$ 200,000.00 \$ 67,760.00 \$ 115,000.00 \$ - \$ - \$ - \$ 10,000.00

Medina Well: Phase 1 - Planning/Engineering/Environmental

Task No.:	Task Description:	Cost:	DWR:	SWRCB:	USDA:	HMGP:	SRF:	District:	Completion Date:
1	Project Evaluations and Pre-Design Engineering	\$ 10,000.00			\$ 10,000.00				5/15/2015
2	Plans, Specifications, and Estimates (PS&E)	\$ 30,000.00			\$ 30,000.00				5/31/2015
3	Environmental Documents	\$ 3,500.00			\$ 3,500.00				5/31/2015
4	Right-of-Way (ROW) Acquisition	\$ 182,440.00			\$ 182,440.00				5/15/2015
5	Permitting	\$ 1,500.00			\$ 1,500.00				7/15/2015
6	Project Management	\$ 10,000.00			\$ 10,000.00				7/31/2015
Total:		\$ 237,440.00	\$ -	\$ -	\$ 237,440.00	\$ -	\$ -	\$ -	

Medina Well: Phase 2 - Construction

Task No.:	Task Description:	Cost:	DWR:	SWRCB:	USDA:	HMGP:	SRF:	District:	Completion Date:
1	Existing Well, Sampling, Logging, Testing	\$ 10,000.00		\$ 10,000.00					5/15/2015
2	Remove Existing Casing, Ream Out Existing Hole, Install Casing and Screening, Development, and Testing	\$ 50,000.00		\$ 50,000.00					5/31/2015
3	Well Equipping, Mechanical, Electrical, and Controls	\$ 60,000.00		\$ 60,000.00					6/30/2015
4	Site Improvements and Fencing	\$ 10,000.00		\$ 10,000.00					6/30/2015
5	Power Source Improvements	\$ 25,000.00		\$ 5,040.00	\$ 19,960.00				6/30/2015
6	Connection to Raw Water System, Pipe, Valving, Surface Restoration	\$ 75,000.00			\$ 75,000.00				6/30/2015
	Contingency (12%)	\$ 27,600.00			\$ 27,600.00				6/30/2015
Total:		\$ 257,600.00	\$ -	\$ 135,040.00	\$ 122,560.00	\$ -	\$ -	\$ -	

Medina Well: Phase 3 - Construction Management/Inspection/Project Closeout

Task No.:	Task Description:	Cost:	DWR:	SWRCB:	USDA:	HMGP:	SRF:	District:	Completion Date:
1	Resident Engineering	\$ 10,000.00			\$ 10,000.00				6/30/2015
2	Construction Surveying	\$ 2,500.00			\$ 2,500.00				6/30/2015
3	Inspection	\$ 10,000.00			\$ 10,000.00				6/30/2015
4	Project Closeout	\$ 2,500.00			\$ 2,500.00				7/31/2015
Total:		\$ 25,000.00	\$ -	\$ -	\$ 25,000.00	\$ -	\$ -	\$ -	

Medina Well Total: \$ 520,040.00 \$ - \$ 135,040.00 \$ 385,000.00 \$ - \$ - \$ - \$ -

Wells 3 & 4: Phase 1 - Planning/Engineering/Environmental

Task No.:	Task Description:	Cost:	DWR:	SWRCB:	USDA:	HMGP:	SRF:	District:	Completion Date:
1	Project Evaluations and Pre-Design Engineering	\$ 25,000.00				\$ 25,000.00			3/31/2015
2	Plans, Specifications, and Estimates (PS&E)	\$ 100,000.00				\$ 100,000.00			5/31/2015
3	Environmental Documents	\$ 25,000.00				\$ 25,000.00			5/31/2015
4	Right-of-Way (ROW) Acquisition	\$ 50,000.00				\$ 50,000.00			5/31/2015
5	Permitting	\$ 10,000.00				\$ 10,000.00			
6	Project Management	\$ 25,000.00				\$ 25,000.00			
Total:		\$ 235,000.00	\$ -	\$ -	\$ -	\$ 235,000.00	\$ -	\$ -	

Wells 3 & 4: Phase 2 - Construction

Task No.:	Task Description:	Cost:	DWR:	SWRCB:	USDA:	HMGP:	SRF:	District:	Completion Date:
1	Test Hole Drilling, Sampling, Logging, Testing (Assume 2 Test Holes)	\$ 22,000.00				\$ 22,000.00			3/31/2015
2	Well Drilling, Install Casing and Screening, Development, and Testing	\$ 100,000.00				\$ 100,000.00			6/30/2015
3	Well Equipping, Mechanical, Electrical, and Controls	\$ 120,000.00				\$ 120,000.00			7/15/2015
4	Site Improvements and Fencing	\$ 20,000.00				\$ 20,000.00			7/15/2015
5	Power Source Improvements	\$ 100,000.00				\$ 100,000.00			7/15/2015
6	Connection to Water System, Pipe, Valving, Surface Restoration	\$ 50,000.00				\$ 50,000.00			7/15/2015
7	Portable Water Treatment Plant	\$ 275,000.00				\$ 103,000.00	\$ 172,000.00		10/31/2015
	Contingency (20%)	\$ 96,000.00				\$ 96,000.00			10/31/2015
Total:		\$ 783,000.00	\$ -	\$ -	\$ -	\$ 515,000.00	\$ 268,000.00	\$ -	

Wells 3 & 4: Phase 3 - Construction Management/Inspection/Project Closeout

Task No.:	Task Description:	Cost:	DWR:	SWRCB:	USDA:	HMGP:	SRF:	District:	Completion Date:
1	Resident Engineering	\$ 30,000.00					\$ 30,000.00		10/31/2015
2	Construction Surveying	\$ 7,500.00					\$ 7,500.00		10/31/2015
3	Inspection	\$ 30,000.00					\$ 30,000.00		10/31/2015
4	Project Closeout	\$ 5,000.00					\$ 5,000.00		11/30/2015
Total:		\$ 72,500.00	\$ -	\$ -	\$ -	\$ -	\$ 72,500.00	\$ -	

Well 3 & 4 Total: \$ 1,090,500.00 \$ - \$ - \$ - \$ 750,000.00 \$ 340,500.00 \$ -

Grand Total: \$ 2,003,300.00 \$ 200,000.00 \$ 202,800.00 \$ 500,000.00 \$ 750,000.00 \$ 340,500.00 \$ 10,000.00

Lake Don Pedro CSD  
Water Drought Accounts

Invoice Date	Payee	Water Supply Emergency	SWRCB Well #2	State Water Board	Dept of Water
		2014 01-1-5020-535	01-9-6030-584	Barge Reimb 01-9-6030-585	Resources 01-9-6030-586
1/27/2015	Binkley Associates	1,706.50			
1/27/2015	Conservation Warehouse	54.50			
1/31/2015	Binkley Associates	332.50			
1/31/2015	Binkley Associates	595.00			
1/31/2015	Binkley Associates	1,517.50			
1/31/2015	Binkley Associates	910.00			
1/31/2015	Binkley Associates	122.50			
1/31/2015	Binkley Associates	181.00			
1/31/2015	Binkley Associates	2,582.00			
1/31/2015	Copy King Printers	641.45			
1/31/2015	Maskell Pipe & Supply	1,746.10			
1/31/2015	Kampa Solutions	4,860.00			
2/16/2015	Binkley Associates	1,400.00			
2/23/2015	Maskell Pipe & Supply	9,199.00			
2/23/2015	Danny Johnson	41.94			
2/24/2015	KKI Corp	2,058.75			
2/25/2015	Canepa and Sons				8,900.00
2/25/2015	Canepa and Sons				12,820.00
2/25/2015	Canepa and Sons				10,400.00
2/25/2015	Canepa and Sons				11,800.00
2/28/2015	Fastenal			162.83	
2/28/2015	Don Pedro Market	36.75			
2/28/2015	Lawson & Son	1,100.00			
3/3/2015	Canepa and Sons				1,250.00
3/3/2015	Canepa and Sons				1,250.00
3/3/2015	Canepa and Sons				1,250.00
3/3/2015	Canepa and Sons				1,250.00
3/3/2015	Canepa and Sons				1,250.00
3/3/2015	Canepa and Sons				10,400.00
3/3/2015	Canepa and Sons				4,640.00
3/6/2015	Union Democrat	116.30			
3/10/2015	Canepa and Sons				9,400.00
3/11/2015	Canepa and Sons				5,200.00
3/17/2015	Griswold	400.40			
3/17/2015	KKI Corp	375.21			
3/17/2015	Danny Johnson	51.93			
3/20/2015	Don Pedro Market	20.78			
3/24/2015	The Source Group Inc		2,500.00		
3/24/2015	Binkley Associates	2,456.00			
3/26/2015	PG&E	1,000.00			
3/30/2015	Waterford Farm Supply			49.49	
3/30/2015	Green Rubber Kennedy Ag	4,448.44			
3/31/2015	The Source Group Inc	8,123.63			
3/31/2015	Kampa Solutions	7,040.00			
3/31/2015	Kennedy Jenks	37,720.80			
3/31/2015	Griswold	1,287.00			
3/31/2015	KKI Corp	324.00			
4/20/2015	Kampa Solutions	6,400.00			
4/28/2015	Binkley Associates	1,540.00			
4/28/2015	The Source Group Inc	1,330.00			
4/30/2015	Springbrook	3,960.00			
4/30/2015	Canepa and Sons	7,850.00			
4/30/2015	Mariposa County	300.25			
	Totals	113,830.23	2,500.00	212.32	79,810.00
	General Ledger Balance	113,830.23	2,500.00	212.32	79,810.00



# Seasonal Temperature Outlook

Jul-Aug-Sep 2015

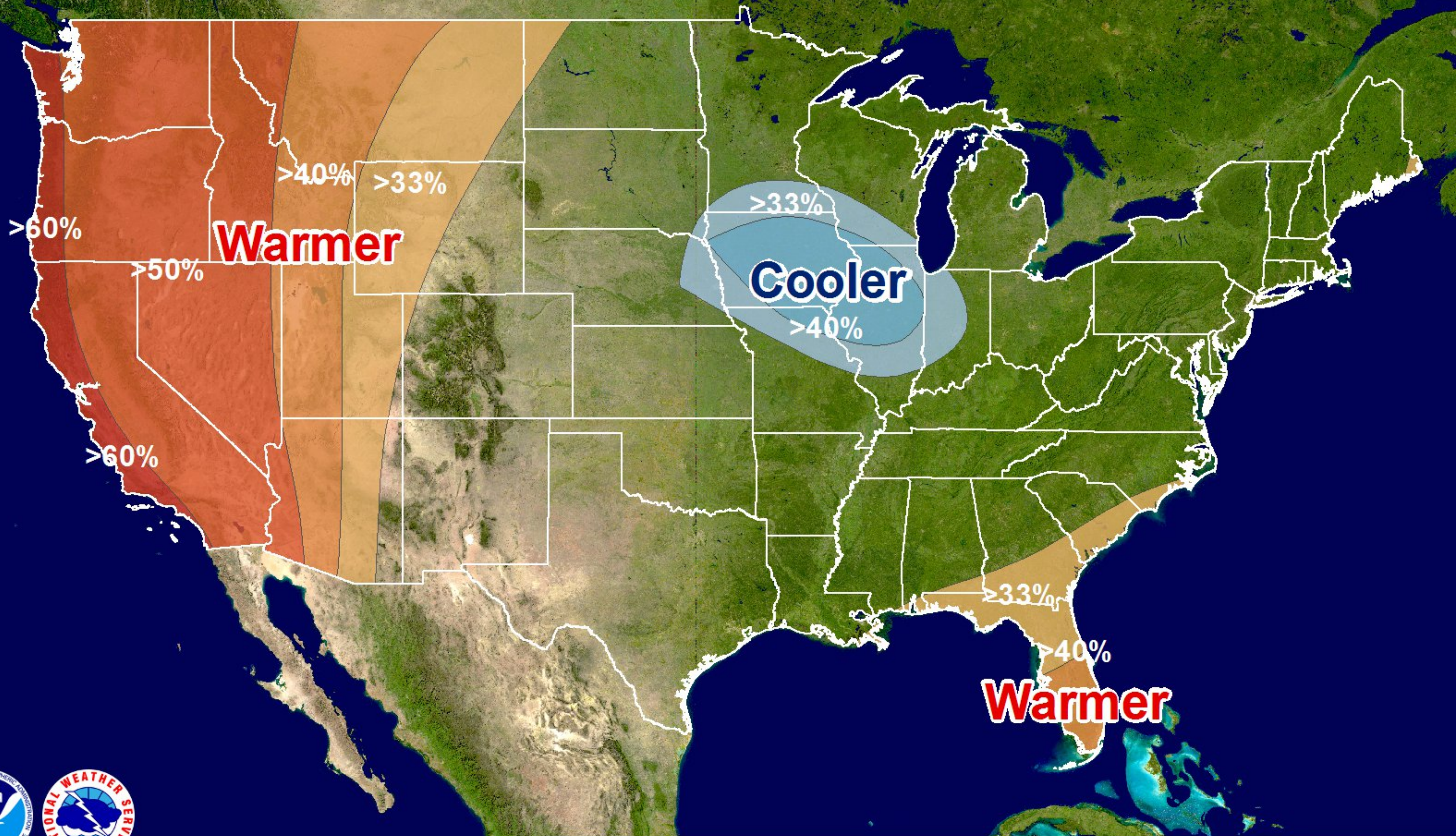

**Climate Prediction Center**

Issued: 04/16/15

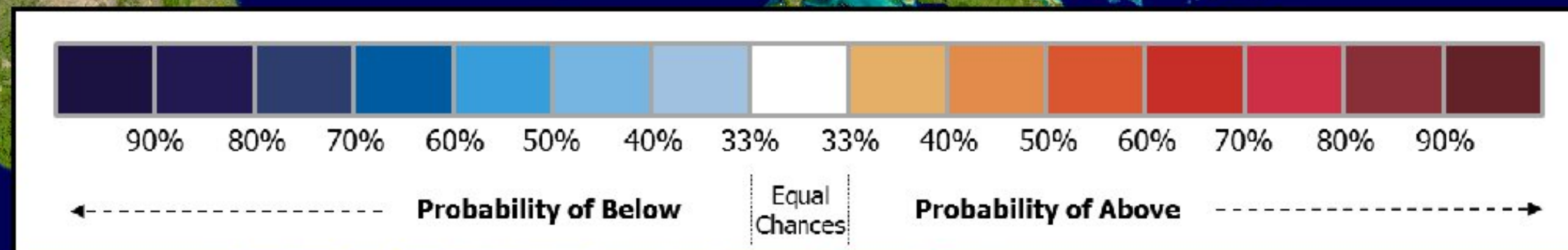



# Seasonal Temperature Outlook

May-Jun-Jul 2015

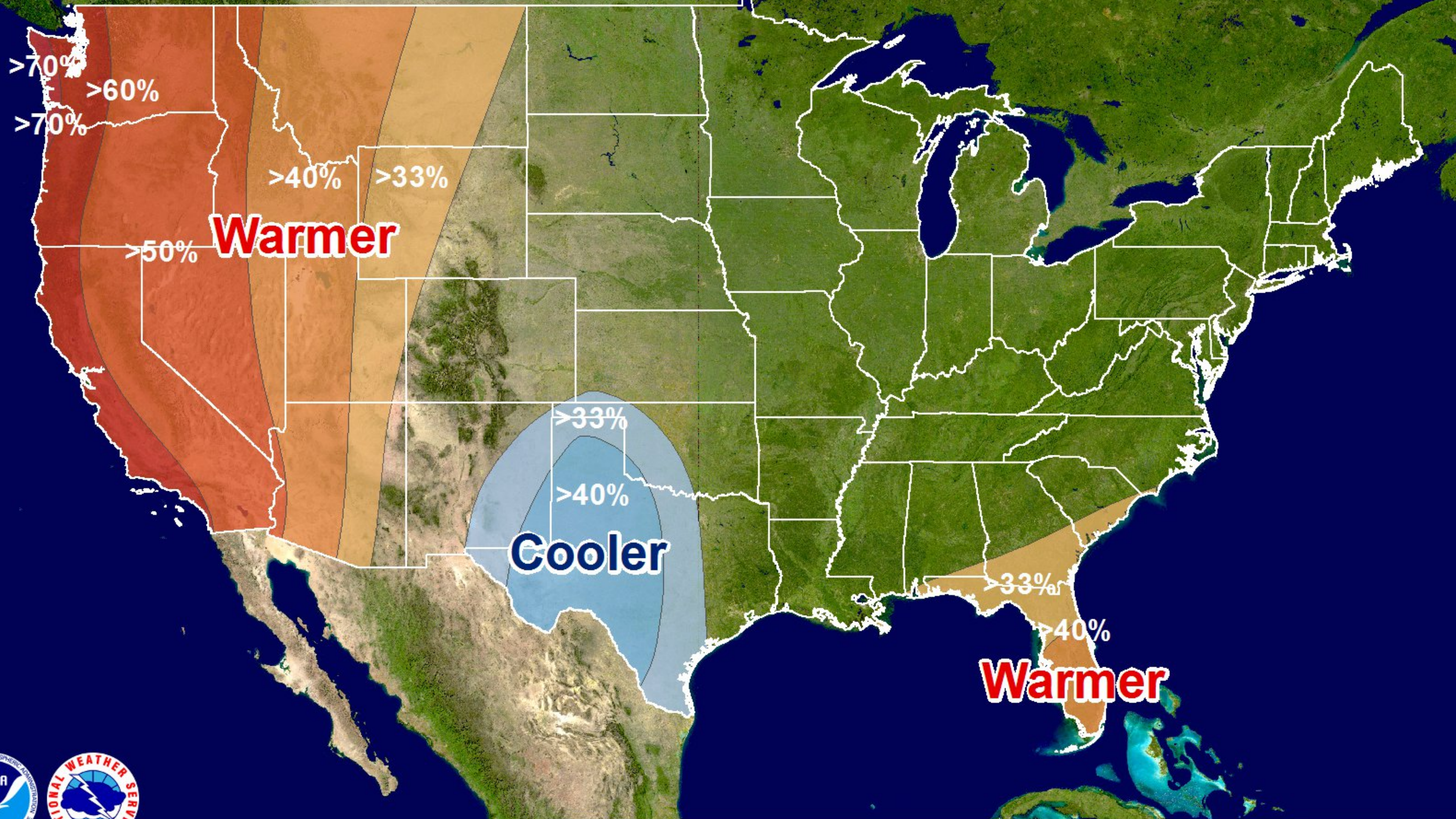

Climate Prediction Center

Issued: 04/16/15

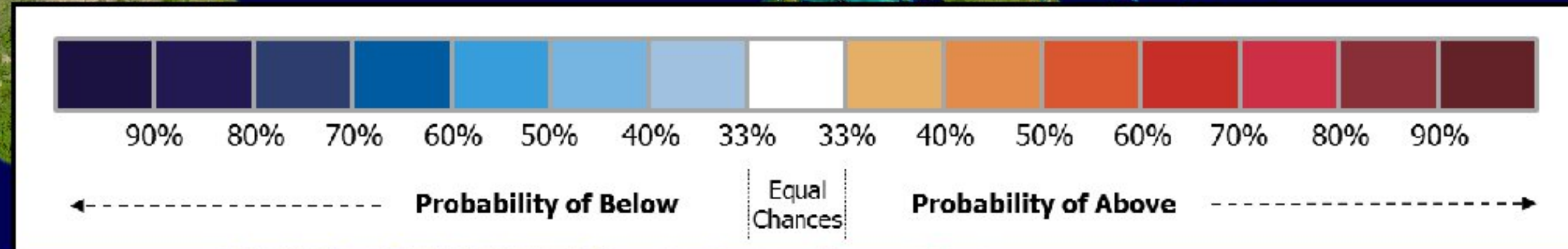



# Seasonal Precipitation Outlook

Jul-Aug-Sep 2015

**Drier**  
>40% >33%

**Wetter**

>40%

>33%

**Drier**  
>40%

>33%



**Climate Prediction Center**

Issued: 04/16/15

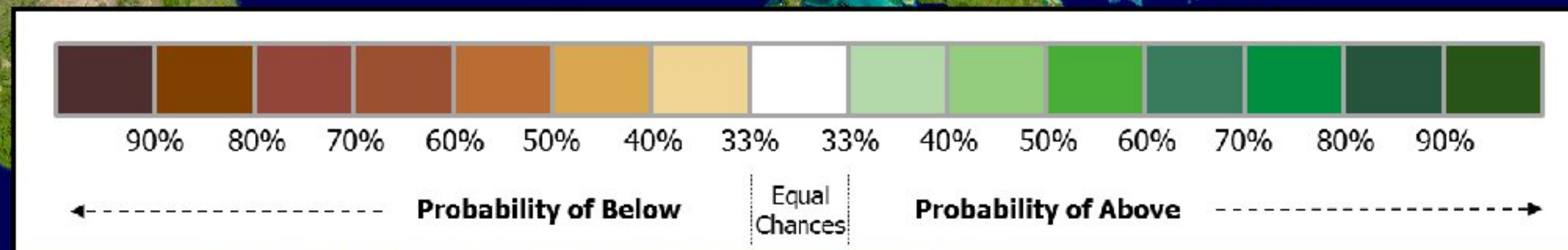



# Seasonal Precipitation Outlook

May-Jun-Jul 2015

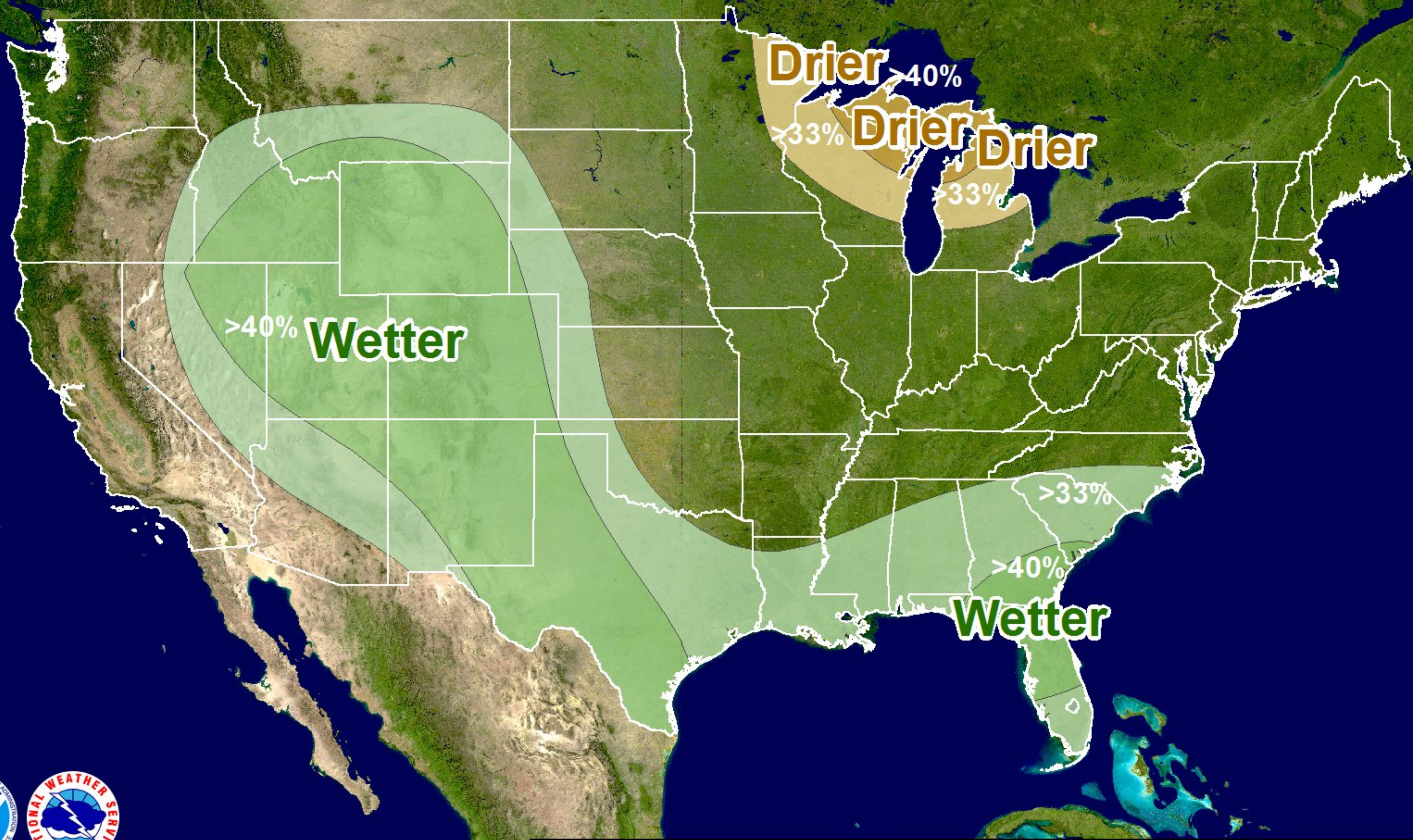

Climate Prediction Center

Issued: 04/16/15

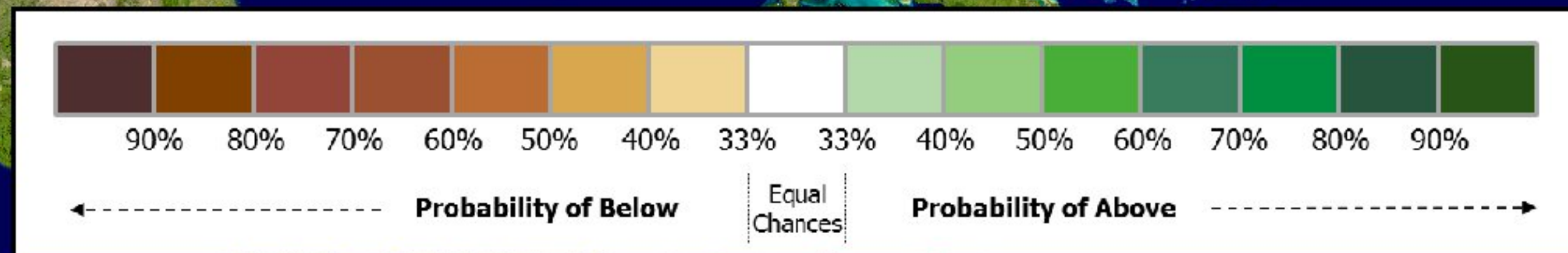





# Reservoir Conditions

Ending At Midnight - April 22, 2015

## CURRENT RESERVOIR CONDITIONS

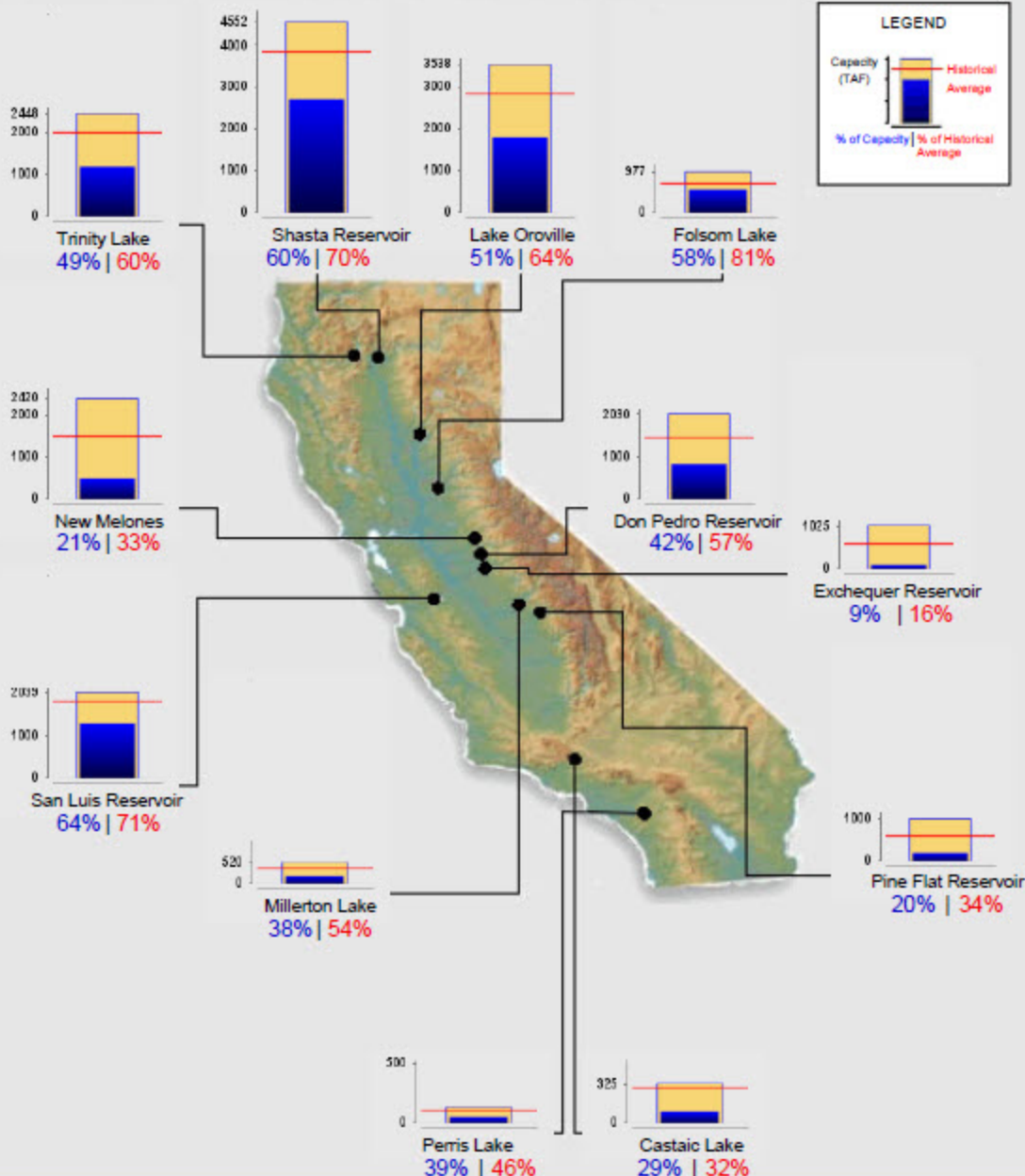

# Lake Don Pedro Community Services District

## Regular Meeting of May 18, 2015

### AGENDA SUPPORTING DATA

#### 5. DISCUSSION AND ACTION ITEMS:

- c. Consideration of development of a Water Conservation Plan and/or limitations on outside irrigation to two days per week in compliance with the State Water Resources Control Board, Emergency Water Conservation regulations adopted May 5, 2015.

#### **Background**

The State Water Resources Control Board (SWRCB) on May 6, 2015 adopted emergency water conservation regulations. As a public water system, we are required to comply with these regulations, and face fines if we do not. We do not meet the definition of an Urban Water Provider, which is a system serving over 3000 (active) connections or 3000 acre feet of water per year.

To comply with the regulations, we are required to either limit outside watering to two days per week, or adopt a water conservation program that produces a 25% reduction in water produced from our treatment plant and delivered into the water system.

During this agenda item, we will discuss the advantages and disadvantages of each compliance method.

#### **Recommended Motion**

Recommended actions to be discussed during the meeting.

**STATE WATER RESOURCES CONTROL BOARD  
RESOLUTION NO. 2015-0032**

**TO ADOPT AN EMERGENCY REGULATION FOR  
STATEWIDE URBAN WATER CONSERVATION**

**WHEREAS:**

1. On April 25, 2014, Governor Edmund G. Brown Jr. issued an executive order (April 2014 Proclamation) to strengthen the State's ability to manage water and habitat effectively in drought conditions, and called on all Californians to redouble their efforts to conserve water. The April 2014 Proclamation finds that the continuous severe drought conditions present urgent challenges across the State, including water shortages in communities and for agricultural production, increased wildfires, degraded habitat for fish and wildlife, threat of saltwater contamination, and additional water scarcity, if drought conditions continue into 2015. The April 2014 Proclamation also suspends the environmental review required by the California Environmental Quality Act to allow the emergency regulation and other actions to take place as quickly as possible;
2. The April 2014 Proclamation refers to the [Governor's Proclamation No. 1-17-2014](#), issued on January 17, 2014, declaring a drought State of Emergency to exist in California due to severe drought conditions (January 2014 Proclamation). The January 2014 Proclamation finds that dry conditions and lack of precipitation present urgent problems to drinking water supplies and cultivation of crops, which put farmers' long-term investments at risk. The conditions also threaten the survival of animals and plants that rely on California's rivers, including many species in danger of extinction. The January 2014 Proclamation also calls on all Californians to reduce their water usage by 20 percent;
3. On December 22, 2014, in light of the continued lack of rain, Governor Brown issued [Executive Order B-28-14](#), which extends the California Environmental Quality Act suspension through May 31, 2016 for Water Code section 13247 and certain activities identified in the January 2014 and April 2014 proclamations;
4. On April 1, 2015, Governor Brown issued a new Executive Order that directs the State Water Board to impose restrictions on urban water suppliers to achieve a statewide 25 percent reduction in potable urban usage through February 2016; require commercial, industrial, and institutional users to implement water efficiency measures; prohibit irrigation with potable water of ornamental turf in public street medians; and prohibit irrigation with potable water outside newly constructed homes and buildings that is not delivered by drip or microspray systems; along with other directives;
5. Water Code section 1058.5 grants the State Water Board the authority to adopt emergency regulations in certain drought years in order to: "prevent the waste, unreasonable use, unreasonable method of use, or unreasonable method of diversion, of water, to promote water recycling or water conservation, to require curtailment of diversions when water is not available under the diverter's priority of right, or in furtherance of any of the foregoing, to require reporting of diversion or use or the preparation of monitoring reports";

6. On July 15, 2014, the State Water Board adopted an emergency regulation to support water conservation ([Resolution No. 2014-0038](#)), and that regulation became effective July 28, 2014 upon approval by the Office of Administrative Law (OAL);
7. On March 17, 2015, the State Water Board amended and readopted the emergency regulation to support water conservation ([Resolution No. 2015-0013](#)), which became effective March 27, 2015 upon approval by OAL;
8. The current emergency regulation has supported Californians' water conservation efforts, with over 125 billion gallons saved from August 2014 through March 2015; however, statewide water use is only nine percent less than the same months in 2013. Achieving a 25 percent reduction in use will require even greater conservation efforts across the state. In particular, many communities must dramatically reduce their outdoor water use;
9. In many areas, 50 percent or more of daily water use is for lawns and outdoor landscaping. Outdoor water use is generally discretionary, and many irrigated landscapes will survive while receiving a decreased amount of water;
10. Although urban water suppliers have placed restrictions on outdoor watering, the State Water Board continues to receive reports of excessive outdoor water use;
11. Water conservation is the easiest, most efficient and most cost-effective way to quickly reduce water demand and extend supplies into the next year, providing flexibility for all California communities. Water saved this summer is water available later in the season or next year, reducing the likelihood of even more severe water shortages should the drought continue;
12. Education and enforcement against water waste is a key tool in conservation programs. When conservation becomes a social norm in a community, the need for enforcement is reduced or eliminated;
13. Public information and awareness is critical to achieving conservation goals, and the Save Our Water campaign, run jointly by the Department of Water Resources (DWR) and the Association of California Water Agencies, is an excellent resource for conservation information and messaging that is integral to effective drought response (<http://saveourwater.com>);
14. Many California communities are facing social and economic hardship due to this drought. The rest of us can make adjustments to our water use, including landscape choices that conserve even more water;
15. The California Constitution declares, at article X, section 2, that the water resources of the state must be put to beneficial use in a manner that is reasonable and not wasteful. Relevant to the current drought conditions, the California Supreme Court has clarified that "what may be a reasonable beneficial use, where water is present in excess of all needs, would not be a reasonable beneficial use in an area of great scarcity and great need. What is a beneficial use at one time may, because of changed conditions, become a waste of water at a later time." (*Tulare Dist. v. Lindsay Strathmore Dist.* (1935) 3 Cal.2d 489, 567.) In support of water conservation, the legislature has, through Water Code section 1011, deemed reductions in water use due to conservation as equivalent

to reasonable beneficial use of that water. Accordingly, this regulation is in furtherance of article X, section 2 during this drought emergency. This temporary emergency regulation is not to be used in any future administrative or judicial proceedings as evidence or finding of waste and unreasonable use of any individual water user or water supplier subject to this regulation, and are not to affect or otherwise limit any rights to water conserved under applicable law, including without limitation, water conserved consistent with Water Code section 1011;

16. Directive two of the Governor's April 1, 2015 Executive Order directs the State Water Board to consider the relative per capita usage of each urban water supplier's service area and require that areas with high per capita use achieve proportionally greater reductions than areas with low per capita use;
17. On April 7, 2015, the State Water Board issued a draft framework proposing increasing levels of required water reduction based upon residential per capita per day use (R-GPCD) for the proposed regulation, and solicited public comments. The Board received over 300 comments on the framework, primarily relating to the levels of required water reduction;
18. On April 18, the State Water Board issued draft regulatory language for public comment based on the April 7 framework and the comments received. The draft regulatory language reflected careful consideration of all comments including those directed at the levels of required reduction. Again, the Board received close to 300 comments;
19. On April 28, 2015, the State Water Board issued a final version of draft regulatory language for comment, followed on April 29 by a formal public notice that it would consider the adoption of the emergency regulation at the Board's regularly-scheduled May 5 and 6, 2015 public meeting, in accordance with applicable State laws and regulations. The State Water Board also distributed for public review and comment a Finding of Emergency that complies with State laws and regulations;
20. As discussed above, the State Water Board is adopting the emergency regulation because of the continuing emergency drought conditions, the need for prompt action to prevent the waste and unreasonable use of water and to promote conservation, and the specific actions called for in the Governor's April 1, 2015 Executive Order; and
21. Nothing in the regulation or in the enforcement provisions of the regulation precludes a local agency from exercising its authority to adopt more stringent conservation measures. Moreover, the Water Code does not impose a mandatory penalty for violations of the regulation adopted by this resolution, and local agencies retain the enforcement discretion in enforcing the regulation to the extent authorized. Local agencies are encouraged to develop their own progressive enforcement practices to promote conservation.

THEREFORE BE IT RESOLVED THAT:

1. The State Water Board adopts California Code of Regulations, title 23, section 866 and re-adopts sections 863, 864, and 865, as appended to this resolution as an emergency regulation;

2. State Water Board staff will submit the regulation to OAL for final approval;
3. If, during the approval process, State Water Board staff, the State Water Board, or OAL determines that minor corrections to the language of the regulation or supporting documentation are needed for clarity or consistency, the State Water Board Executive Director or the Executive Director's designee may make such changes;
4. This regulation shall remain in effect for 270 days after filing with the Secretary of State unless the State Water Board determines that it is no longer necessary due to changed conditions, or unless the State Water Board renews the regulation due to continued drought conditions as described in Water Code section 1058.5;
5. The State Water Board directs staff to provide the Board with monthly updates on the implementation of the emergency regulation and its effect. These updates shall include information regarding the progress of the Building Standards Commission, Department of Housing and Community Development, and other state agencies in the adoption and implementation of emergency regulations or other requirements that implement increased outdoor irrigation efficiency for new construction. These regulations and other requirements will extend existing efficiency standards for new construction to the outdoor environment and ensure that California's new homes are constructed to meet the growing demand with the most efficient standards;
6. The State Water Board directs staff to condition funding upon compliance with the emergency regulation, to the extent feasible;
7. The State Water Board directs staff to work with DWR and the Save Our Water campaign to disseminate information regarding the emergency regulation; and
8. The State Water Board directs staff to update the electronic reporting portal to include data fields for the new reporting required by the emergency regulation.

THEREFORE BE IT FURTHER RESOLVED THAT:

9. The State Water Board shall work with DWR, the Public Utilities Commission, and other agencies to support urban water suppliers' actions to implement rates and pricing structures to incent additional conservation, as required by directive eight in the Governor's April 1, 2015 Executive Order. The Fourth District Court of Appeal's recent Decision in *Capistrano Taxpayer Association Inc. v. City of San Juan Capistrano* (G048969) does not foreclose the use of conservation-oriented rate structures;
10. The State Water Board calls upon water suppliers to:
  - a. ensure that adequate personnel and financial resources exist to implement conservation requirements not only for 2015, but also for another year of drought should it occur. Water suppliers that face budget shortfalls due to reduced sales should take immediate steps to raise necessary revenues in a way that actively promotes continued conservation;
  - b. expedite implementation of new conservation programs by minimizing internal review periods and utilizing emergency authorities, as appropriate;



- c. consider the relative water use and conservation practices of their customers and target those with higher water use to achieve proportionally greater reductions than those with low use;
  - d. minimize financial impacts to low-income customers;
  - e. preserve safe indoor water supplies in areas with very low R-GPCD and where necessary to protect public health and safety;
  - f. promote low-water use methods of preserving appropriate defensible space in fire-prone areas, consistent with local fire district requirements;
  - g. educate customers on the preservation of trees;
  - h. promote on-site reuse of water; and
  - i. promptly notify staff of the supplier's need for an alternate method of compliance pursuant to resolved paragraph 16.
11. The State Water Board calls upon all businesses within California's travel and tourism sectors to inform visitors of California's dire drought situation and actions visitors should take to conserve water;
  12. The State Water Board commends wholesale water agencies that have set aggressive conservation targets for their retail water suppliers;
  13. The State Water Board commends water suppliers that have made investments to boost drought-resistant supplies, such as advanced treated recycled water and desalination. Those investments help to make communities more resilient in the face of drought;
  14. The State Water Board commends the many water suppliers that have already surpassed their 20x2020 conservation targets. Long-term conservation efforts are critical to maintaining economic and social well-being, especially in light of the impacts of climate change on California's hydrology;
  15. During this drought emergency, heightened conservation that extends urban resilience is necessary. The State Water Board's focus is primarily on immediate reductions in outdoor water use. Some short-term conservation efforts, such as landscape conversions and installation of efficient appliances, will also support long-term conservation objectives, and are encouraged wherever possible;
  16. The State Water Board recognizes that some commercial and industrial customers, while accounting for a significant portion of total use in a service area, have already taken steps to significantly reduce their water consumption and cannot further reduce their use without substantial impacts. However, the Board also recognizes that in many areas there are significant opportunities for reductions in water use by industries and commercial enterprises that have yet to take action, especially those with large areas of non-functional turf. The Board directs staff to respond promptly upon receipt of any request for alternate enforceable methods of compliance. If the supplier believes the conservation standard is unachievable due to firm commercial and industrial water use

and residential use reductions that would affect public health and safety, it should provide any supporting information or documentation for an alternate method of compliance; and

17. Some water suppliers have called for further refinement of the tiers to reflect a range of factors that contribute to water use, including but not limited to temperature, lot size, and income. Others have called for an approach that provides greater recognition for early investments in conservation, the development of local, drought resistant water supplies, and health and safety needs. These suggestions and many others are important considerations in the development of a more comprehensive, and long term, conservation framework. The State Water Board directs staff to work with stakeholders on a thoughtful process to devise options for extended and expanded emergency regulations should the drought continue into 2016.

### CERTIFICATION

The undersigned Clerk to the Board does hereby certify that the foregoing is a full, true, and correct copy of a resolution duly and regularly adopted at a meeting of the State Water Resources Control Board held on May 5, 2015.

AYE:            Chair Felicia Marcus  
                    Vice Chair Frances Spivy-Weber  
                    Board Member Tam M. Doduc  
                    Board Member Steven Moore  
                    Board Member Dorene D'Adamo

NAY:            None

ABSENT:        None

ABSTAIN:       None



---

Jeanine Townsend  
Clerk to the Board

# ADOPTED TEXT OF EMERGENCY REGULATION

## Article 22.5. Drought Emergency Water Conservation.

### Sec. 863. Findings of Drought Emergency.

(a) The State Water Resources Control Board finds as follows:

(1) On January 17, 2014, the Governor issued a proclamation of a state of emergency under the California Emergency Services Act based on drought conditions;

(2) On April 25, 2014, the Governor issued a proclamation of a continued state of emergency under the California Emergency Services Act based on continued drought conditions;

(3) On April 1, 2015, the Governor issued an Executive Order that, in part, directs the State Board to impose restrictions on water suppliers to achieve a statewide 25 percent reduction in potable urban usage through February, 2016; require commercial, industrial, and institutional users to implement water efficiency measures; prohibit irrigation with potable water of ornamental turf in public street medians; and prohibit irrigation with potable water outside newly constructed homes and buildings that is not delivered by drip or microspray systems;

(4) The drought conditions that formed the basis of the Governor's emergency proclamations continue to exist;

(5) The present year is critically dry and has been immediately preceded by two or more consecutive below normal, dry, or critically dry years; and

(6) The drought conditions will likely continue for the foreseeable future and additional action by both the State Water Resources Control Board and local water suppliers will likely be necessary to prevent waste and unreasonable use of water and to further promote conservation.

Authority: Section 1058.5, Water Code.

References: Cal. Const., Art., X § 2; Sections 102, 104, 105, and 275, Water Code; *Light v. State Water Resources Control Board* (2014) 226 Cal.App.4th 1463.

### Sec. 864. End-User Requirements in Promotion of Water Conservation.

(a) To prevent the waste and unreasonable use of water and to promote water conservation, each of the following actions is prohibited, except where necessary to address an immediate health and safety need or to comply with a term or condition in a permit issued by a state or federal agency:

(1) The application of potable water to outdoor landscapes in a manner that causes runoff such that water flows onto adjacent property, non-irrigated areas, private and public walkways, roadways, parking lots, or structures;

(2) The use of a hose that dispenses potable water to wash a motor vehicle, except where the hose is fitted with a shut-off nozzle or device attached to it that causes it to cease dispensing water immediately when not in use;

(3) The application of potable water to driveways and sidewalks; and

(4) The use of potable water in a fountain or other decorative water feature, except where the water is part of a recirculating system;

(5) The application of potable water to outdoor landscapes during and within 48 hours after measurable rainfall;

(6) The serving of drinking water other than upon request in eating or drinking establishments, including but not limited to restaurants, hotels, cafes, cafeterias, bars, or other public places where food or drink are served and/or purchased;

(7) The irrigation with potable water of ornamental turf on public street medians; and

(8) The irrigation with potable water of landscapes outside of newly constructed homes and buildings in a manner inconsistent with regulations or other requirements established by the California Building Standards Commission and the Department of Housing and Community Development.

(b) To promote water conservation, operators of hotels and motels shall provide guests with the option of choosing not to have towels and linens laundered daily. The hotel or motel shall prominently display notice of this option in each guestroom using clear and easily understood language.

(c) Immediately upon this subdivision taking effect, all commercial, industrial and institutional properties that use a water supply, any portion of which is from a source other than a water supplier subject to section 865, shall either:

(1) Limit outdoor irrigation of ornamental landscapes or turf with potable water to no more than two days per week; or

(2) Reduce potable water usage supplied by sources other than a water supplier by 25 percent for the months of June 2015 through February 2016 as compared to the amount used from those sources for the same months in 2013.

(d) The taking of any action prohibited in subdivision (a) or the failure to take any action required in subdivisions (b) or (c), is an infraction, punishable by a fine of up to five hundred dollars (\$500) for each day in which the violation occurs. The fine for the infraction is in addition to, and does not supersede or limit, any other remedies, civil or criminal.

Authority: Section 1058.5, Water Code.

References: Cal. Const., Art., X § 2; Sections 102, 104, 105, 275, 350, and 10617, Water Code; *Light v. State Water Resources Control Board* (2014) 226 Cal.App.4th 1463.

#### Sec. 865. Mandatory Actions by Water Suppliers.

(a) As used in this section:

(1) “Distributor of a public water supply” has the same meaning as under section 350 of the Water Code, except it does not refer to such distributors when they are functioning solely in a wholesale capacity, but does apply to distributors when they are functioning in a retail capacity.

(2) “R-GPCD” means residential gallons per capita per day.

- (3) "Total potable water production" means all potable water that enters into a water supplier's distribution system, excluding water placed into storage and not withdrawn for use during the reporting period, or water exported outside the supplier's service area.
- (4) "Urban water supplier" means a supplier that meets the definition set forth in Water Code section 10617, except it does not refer to suppliers when they are functioning solely in a wholesale capacity, but does apply to suppliers when they are functioning in a retail capacity.

(b) In furtherance of the promotion of water conservation each urban water supplier shall:

(1) Provide prompt notice to a customer whenever the supplier obtains information that indicates that a leak may exist within the end-user's exclusive control.

(2) Prepare and submit to the State Water Resources Control Board by the 15<sup>th</sup> of each month a monitoring report on forms provided by the Board. The monitoring report shall include the amount of potable water the urban water supplier produced, including water provided by a wholesaler, in the preceding calendar month and shall compare that amount to the amount produced in the same calendar month in 2013. The monitoring report shall specify the population served by the urban water supplier, the percentage of water produced that is used for the residential sector, descriptive statistics on water conservation compliance and enforcement efforts, and the number of days that outdoor irrigation is allowed, and monthly commercial, industrial and institutional sector use. The monitoring report shall also estimate the gallons of water per person per day used by the residential customers it serves.

(c)(1) To prevent the waste and unreasonable use of water and to meet the requirements of the Governor's April 1, 2015 Executive Order, each urban water supplier shall reduce its total potable water production by the percentage identified as its conservation standard in this subdivision. Each urban water supplier's conservation standard considers its service area's relative per capita water usage.

(2) Each urban water supplier whose source of supply does not include groundwater or water imported from outside the hydrologic region in which the water supplier is located, and that has a minimum of four years' reserved supply available may, submit to the Executive Director for approval a request that, in lieu of the reduction that would otherwise be required under paragraphs (3) through (10), the urban water supplier shall reduce its total potable water production by 4 percent for each month as compared to the amount used in the same month in 2013. Any such request shall be accompanied by information showing that the supplier's sources of supply do not include groundwater or water imported from outside the hydrologic region and that the supplier has a minimum of four years' reserved supply available.

(3) Each urban water supplier whose average July-September 2014 R-GPCD was less than 65 shall reduce its total potable water production by 8 percent for each month as compared to the amount used in the same month in 2013.

(4) Each urban water supplier whose average July-September 2014 R-GPCD was 65 or more but less than 80 shall reduce its total potable water production by 12 percent for each month as compared to the amount used in the same month in 2013.

(5) Each urban water supplier whose average July-September 2014 R-GPCD was 80 or more but less than 95 shall reduce its total potable water production by 16 percent for each month as compared to the amount used in the same month in 2013.

(6) Each urban water supplier whose average July-September 2014 R-GPCD was 95 or more but less than 110 shall reduce its total potable water production by 20 percent for each month as compared to the amount used in the same month in 2013.

(7) Each urban water supplier whose average July-September 2014 R-GPCD was 110 or more but less than 130 shall reduce its total potable water production by 24 percent for each month as compared to the amount used in the same month in 2013.

(8) Each urban water supplier whose average July-September 2014 R-GPCD was 130 or more but less than 170 shall reduce its total potable water production by 28 percent for each month as compared to the amount used in the same month in 2013.

(9) Each urban water supplier whose average July-September 2014 R-GPCD was 170 or more but less than 215 shall reduce its total potable water production by 32 percent for each month as compared to the amount used in the same month in 2013.

(10) Each urban water supplier whose average July-September 2014 R-GPCD was 215 or more shall reduce its total potable water production by 36 percent for each month as compared to the amount used in the same month in 2013.

(d)(1) Beginning June 1, 2015, each urban water supplier shall comply with the conservation standard specified in subdivision (c).

(2) Compliance with the requirements of this subdivision shall be measured monthly and assessed on a cumulative basis.

(e)(1) Each urban water supplier that provides potable water for commercial agricultural use meeting the definition of Government Code section 51201, subdivision (b), may subtract the amount of water provided for commercial agricultural use from its potable water production total, provided that any urban water supplier that subtracts any water provided for commercial agricultural use from its total potable water production shall:

(A) Impose reductions determined locally appropriate by the urban water supplier, after considering the applicable urban water supplier conservation standard specified in subdivision (c), for commercial agricultural users meeting the definition of Government Code section 51201, subdivision (b) served by the supplier;

(B) Report its total potable water production pursuant to subdivision (b)(2) of this section, the total amount of water supplied for commercial agricultural use, and shall identify the reduction imposed on its commercial agricultural users and each recipient of potable water for commercial agricultural use;

(C) Certify that the agricultural uses it serves meet the definition of Government Code section 51201, subdivision (b); and

(D) Comply with the Agricultural Water Management Plan requirement of paragraph 12 of the April 1, 2015 Executive Order for all commercial agricultural water served by the supplier that is subtracted from its total potable water production.

(2) Submitting any information pursuant to subdivision (e)(1)(B) or (C) of this section that is found to be materially false by the board is a violation of this regulation, punishable by civil liability of up to five hundred dollars (\$500) for each day in which the violation occurs. Every day that the error goes uncorrected constitutes a separate violation. Civil liability for the violation is in addition to, and does not supersede or limit, any other remedies, civil or criminal.

(f)(1) To prevent waste and unreasonable use of water and to promote water conservation, each distributor of a public water supply that is not an urban water supplier shall take one or more of the following actions:

(A) Limit outdoor irrigation of ornamental landscapes or turf with potable water by the persons it serves to no more than two days per week; or

(B) Reduce by 25 percent reduction its total potable water production relative to the amount produced in 2013.

(2) Each distributor of a public water supply that is not an urban water supplier shall submit a report by December 15, 2015, on a form provided by the Board, that either confirms compliance with subdivision (f)(1)(A) or identifies total potable water production, by month, from June through November, 2015, and total potable water production, by month, for June through November 2013.

Authority: Section 1058.5, Water Code.

References: Cal. Const., Art., X § 2; Sections 102, 104, 105, 275, 350, 1846, 10617 and 10632, Water Code; *Light v. State Water Resources Control Board* (2014) 226 Cal.App.4th 1463.

#### Sec. 866. Additional Conservation Tools.

(a)(1) To prevent the waste and unreasonable use of water and to promote conservation, when a water supplier does not meet its conservation standard required by section 865 the Executive Director, or the Executive Director's designee, may issue conservation orders requiring additional actions by the supplier to come into compliance with its conservation standard.

(2) A decision or order issued under this article by the board or an officer or employee of the board is subject to reconsideration under article 2 (commencing with section 1122) of chapter 4 of part 1 of division 2 of the California Water Code.

(b) The Executive Director, or his designee, may issue an informational order requiring water suppliers, or commercial, industrial or institutional properties that receive any portion of their supply from a source other than a water supplier subject to section 865, to submit additional information relating to water production, water use or water conservation. The failure to provide the information requested within 30 days or any additional time extension granted is a violation subject to civil liability of up to \$500 per day for each day the violation continues pursuant to Water Code section 1846.

Authority: Section 1058.5, Water Code.

References: Cal. Const., Art., X § 2; Sections 100, 102, 104, 105, 174, 186, 187, 275, 350, 1051, 1122, 1123, 1825, 1846, 10617 and 10632, Water Code; *Light v. State Water Resources Control Board* (2014) 226 Cal.App.4th 1463.

# Lake Don Pedro Community Services District

## Regular Meeting of May 18, 2015

### AGENDA SUPPORTING DATA

#### 5. DISCUSSION AND ACTION ITEMS:

- e. Consideration of adoption of an Ordinance restricting the drilling of groundwater wells in the District, due to potential impacts on the emergency groundwater wells.

#### **Background**

During the drilling of the 8 test wells and pump testing of the Medina well, we have discovered that the wells in certain areas of the system are interconnected hydraulically. Additional wells being drilled in the District during this ongoing drought may cause depletion of our emergency wells, at a time when we may be relying solely on groundwater to meet the human consumption, fire protection and sanitation water needs of the community.

The District has the legal authority to adopt restrictions on the drilling of wells within the District boundaries.

#### **Recommended Motion**

I move to direct the General Manager to prepare an ordinance to restrict the installation of groundwater wells within the District.



# Lake Don Pedro Community Services District

## Regular Meeting of May 18, 2015

### AGENDA SUPPORTING DATA

#### 5. DISCUSSION AND ACTION ITEMS:

- f. Discussion regarding the requirements and opportunities related to the use of greywater and rainwater for landscape irrigation.

#### **Background**

California law was amended in 2009 to allow for the use of rainwater and greywater for residential landscape irrigation. The California Plumbing Code contains specific requirements for the installation and operation of these systems, primarily for the purpose of protecting public health and protecting home buyers. Mariposa and Tuolumne Counties have also adopted requirements for greywater and rainwater system construction.

Both rainwater and greywater are very significant sources for landscape, garden and tree irrigation. With the ban on outside watering, our customers have two options currently, let their landscape plantings die or use rainwater and greywater for irrigation to keep their plantings minimally alive. Customers have been asking for more information on the use of rainwater and greywater, and our customers located in Tuolumne County will soon have access to subsidy grant funding to help fund the cost of system installation.

I have much training in the area of rainwater and greywater systems, and propose that the District sponsor local workshops and other forums to educate our customers, provide training and assist in facilitating the funding subsidy process. Portions of this effort will be reimbursable under the Tuolumne-Stanislaus IRWMP water conservation grant.

#### **Recommended Motion**

I move to authorize and direct the General Manager to propose a schedule of local rainwater and greywater workshops and/or training.